



AMERICA'S BEST VALUE IN SWING SETS.™

# 7.0 Mega Deck Fort

## Install Manual

Version 6.14



### Tools Needed for Assembly

Tape Measure	24" Level	Angle Square
Phillips Screw Driver	3/8" Cordless Drill or Electric Drill	3/8" Drive Ratchet or Electric Impact Gun
Claw Hammer or Rubber Mallet	Pliers or Vise Grips	7/16" Deep Well Socket
9/16" Deep Well Socket	3/4" Deep Well Socket	1/8", 1/4", and 9/16" Drill Bits
Phillips Head Screw Bits	An Adult with two Adult Helpers	

Please familiarize yourself with the install manual, parts/components and general construction process of your new swing set before getting started. Approximate assembly time: 6 to 8 hours. 6 foot unobstructed safety perimeter around swing set recommended.

## Choosing A Location For Your Playset

When choosing a location for your swing set, always keep your child or children's safety in mind. Here are some recommendations to help you locate and install a safe play area.

- This play set is designed for the use of 4 occupants who have a combined weight not exceeding 800 pounds on the elevated floor; 3 occupants who have a combined weight of 525 pounds on the swing area; for a total Unit capacity of 5 occupants who have a combined weight of 1325. (this weight is not including the picnic table area)
- On-site adult supervision is required.
- The swing set should be located on level ground. The stationary components such as ladders and slides are required to be a minimum of six feet from any structure or obstruction such as a fence, garage, house, tree, overhanging branches, electrical wires, clotheslines, etc. Any swinging equipment is also required to be a minimum distance twice the height of the swing beam away from these obstructions or structures as well. The swing set should be located a safe distance from any water hazards, such as a lake, river, bayou, swimming pool, etc.
- Do not install this residential swing set in a commercial setting. This swing set is not manufactured for commercial usage and will void all warranties. Tree Frogs Wooden Swing Set Factory is not responsible for any damages or injuries resulting from this swing set being used in a commercial setting.
- Never install this swing set indoors; or over concrete, asphalt, packed earth, grass, carpet or any other hard surface. A fall onto a hard surface can result in serious or fatal injury.
- The U.S. Consumer Product Safety Commission (CPSC) recommends that you install and maintain a resilient surface under your swing set. The CPSC's Consumer Information Sheet for Playground Surfacing Materials is on the next page. A resilient surface, should be installed after the swing set has been completely assembled according to these instructions. The swing set must rest on solid ground. Please note that this swing set has a maximum fall height of 7'.

## Maintaining Your Swing Set

Here are some maintenance tips required to insure safe play on your swing set for years of fun.

- At the beginning of each usage season and every two weeks during, check: nuts and bolts and tighten as needed, swing seats, chains, ladders, slides, rope and wood components for sign of deterioration and replace if necessary.
- On a yearly basis, we recommend that you coat your swing set with a sealant or preservative. You may also want to spot sand any areas prior to sealing.

**\*\* Special note:** Although we recommend that you reseal your swing set annually, you may have to touch up the high traffic areas and/or areas that have a high exposure to direct sunlight.\*\*

- Be sure that the sealant you select is non-toxic and child safe. Your local Tree Frogs Wooden Swing Set Factory dealer may offer a complete power wash and reseal and maintenance program.
- Do not use line trimmers or "weed eaters" around your swing set. The line will remove both paint and wood from uprights and base pieces. Any damage resulting from this type of abuse is not covered under our limited warranty.
- Remove plastic swing seats and take in doors or do not use when temperature drops below 0°F.

## Weight Limits for Tree Frogs Swing Sets

Fort Platform: 800 Lbs. Total Weight

Swing Belts: 175 Lbs.

Trapeze: 125 Lbs.

Full Bucket Swing: 50 Lbs.

Toddler Bucket Swing: 50 Lbs.

Tire Swing: 125 Lbs. Total Weight

Rope Ladder: 75 Lbs.

Rock Wall: 150 Lbs.

All Slides: 125 Lbs.

Tree Frogs recommends that the weight limits for all components must not be exceeded. Failure to adhere to these and other safety guidelines could result in damage to the swing set and/or injury to the users.

**Please keep this install manual for future reference.**

## To insure SAFE PLAY adults must teach children:

- Not to walk close to, in front of, behind, or between moving items.
- Not to swing empty swing seats.
- Not to swing sideways into the path of adjacent swings.
- Not to use the swing set in a manner other than that for which it is intended.
- Not to get off the equipment while it is in motion.
- Not to jump off the tower.
- Not to stand in the swing seats.
- Not to swing so high that chains become slack, or above the height of the swing support.
- Not to jump on a slide.
- Not to climb on top of the swing support.
- Not to attach to the swing set any item that is not specifically designed for use with the equipment, such as (but not limited to) jump ropes, clotheslines, pet leashes, cables, and chains. These may become strangulation hazards.
- To hold on to swings and climbers with both hands.
- To slide feet first, never head first.
- To watch for other children while swinging or playing near the swing set.

## To also insure SAFE PLAY adults must:

- Limit climbing and swinging heights to each child's ability.
- Verify that suspended climbing ropes are secured at both ends.
- Verify that suspended climbing ropes cannot be looped back on themselves.
- Dress children appropriately for play. Use well-fitted shoes that do not have slippery soles.
- Avoid ponchos, scarves, hoods, loose fitting clothing, neckties, and any clothing with a drawstring. Serious injury could result should any part of the children's clothing become entangled in the swing set.
- Do not allow children to play wearing helmets.
- Remember that children are inventive. When they develop games that are unsafe, be alert and change the rules.

## IMPORTANT - PLEASE READ

As fresh lumber acclimates to its new environment, the natural tendencies of the tree can show itself in the form of checks, or "cracks" in the lumber. In almost all cases this is normal and it will not affect the structural integrity of your play set.

Cosmetic defects that do not affect the structural integrity of the product, or natural defects of wood such as warping, checking or any other physical properties of wood that do not present a safety hazard, are not covered by this warranty.

Defects that develop because the product is exposed to extreme climate conditions are not covered by this warranty.

Defects that develop as a result of faulty or improper installation of the product are also not covered by this warranty.

Most cracks are not warrantable, however if you believe that the integrity of your play set is compromised by this natural occurrence, please contact the Tree Frogs Swing Set Dealer that you purchased your swing set from.

We appreciate your purchase and know that you will enjoy your play system for many years to come.

## Pre-Assembly Hints

- Depending on your experience, assembly of our play sets can take as little as 6 hours up to 24 hours, depending on size, after inventory of parts; therefore, we recommend you set aside a full two days for assembly.
- Identify all of the parts for your play set. Empty each box and lay out boards so you can see each part. Your instruction book will have detailed drawings that will make it easy for you to recognize individual parts. Keep all hardware and metal parts separate from wooden pieces.
- After everything is laid out, check carefully to ensure all parts are present. Make sure there are no broken boards.
- Find an area to sort your hardware. It is best to open the hardware on a solid surface so that you do not lose any pieces in the grass. This will save time and familiarize you with all the different pieces in the hardware bag.

**\*\*Important note:** Wood has some natural defects such as knots, surface cracks, etc... We reject parts that are structurally defective. We use a high quality lumber in our structures; however, you should inspect each part for splinters or rough spots and sand them smooth to prevent injury.\*\*

- After familiarizing yourself with all of the components, read all instructions thoroughly. Reading instructions after you have studied the parts will help you understand more clearly the installation process, and help to eliminate unnecessary mistakes.
- Pay close attention to the diameter and length of each bolt and screw.
- Never tighten hardware completely at first. It helps to have some adjustment for bolt alignment while you are attaching parts together. After everything is square, tighten each joint.
- After the main unit is assembled it is critical that the floor is level and square. If the main frame is not level, the walls and floor will be out of square.
- After you complete installation, make sure every bolt, screw, and nut is tight, and every board is secure. Wood will expand and contract with the seasons.
- Place the set on level ground, not less than 6ft from any structure or obstruction such as a fence, garage, house, overhanging branches, laundry lines, or electrical wires.
- All 1/4" and 3/8" lag bolts must have pre-drilled holes 1-1/2" to 2" deep. Use a 1/8" drill bit for the 1/4" lag bolts and 1/4" drill bit for 3/8" lag bolts. Use pre-drilled holes in facias as a reference for placing lag bolt pilot holes.
- If a board lifts or rises causing a gap between boards when running in lag bolts or screws, back out the screw or lag bolt and press or apply pressure (but not enough to crack or break board) while re-running in the lag bolt or screw in the same hole.
- Do not over tighten bolts, lag bolts or screws. You can damage boards, break hardware, and/or strip out the hardware.
- When using hammer do not beat on the hardware, but gently tap it in. Never beat on the wood as it will leave marks.

## Leveling Your Swing Set During Assembly

- Complete the steps which will be the basic frame of the fort {i.e. four corner posts with base (sand box boards) and deck supports}
- Position in the most level area chosen for the play set, keeping in mind the location and size of the swing beam, ladder, slides, etc. that extend off the fort.
- Once the frame is in the final position, check for vertical and horizontal levelness to determine which side(s) will need to be dug into the ground to level the play set.
- With a shovel, score the ground around the outside edges of the sandbox boards on the 'high' side of the fort. This is the area that will be dug in. Make sure to score deep enough; the scored lines will be your digging template.
- Push the frame off and away from the scored area, far enough to dig and remove dirt to reach the appropriate depth.
- Dig a channel along the scored line(s) for the base of the fort (corner post and sandbox boards) to rest into. Dig the channel(s) to the same level depth. The bottom of the channel(s) should be level to each other so your frame doesn't teeter or rock because the channel(s) are uneven.
- Once you have removed enough grass and dirt, slide/push the frame into the channel(s). Place a level on the vertical and horizontal boards of the frame to determine if enough soil, or too much, was removed.
- Repeat this process until the basic frame is plumb and level and in its final position before completing the rest of the assembly.
- Measure to make sure fort is square.

**\*\* Important:** if you require a channel depth of more than 6",  
then we recommend you have your play set area professionally graded before completing assembly. \*\*



## CONSUMER INFORMATION SHEET FOR PLAYGROUND SURFACING MATERIALS

The U.S. Consumer Product Safety Commission (CPSC) estimates that about 100,000 playground equipment related injuries resulting from falls to the ground surface are treated annually in U.S. hospital emergency rooms. Injuries involving this hazard pattern tend to be among the most serious of all playground injuries, and have the potential to be fatal, particularly when the injury is to the head. The surface under and around playground equipment can be a major factor in determining the injury-causing potential of a fall. It is self-evident that a fall onto a shock-absorbing surface is less likely to cause a serious injury than a fall onto a hard surface. However, it should be recognized that some injuries from falls will occur no matter what playground surfacing material is used.

Playground equipment should never be placed on hard surfaces such as concrete or asphalt. Grass may appear to be acceptable, but can turn to hard packed earth in areas of high traffic. Shredded bark mulch, wood chips, or fine gravel are considered to be acceptable shock absorbing surfaces when installed and maintained at a sufficient depth under and around play equipment.

TABLE 1 -CRITICAL HEIGHTS (in feet) OF TESTED MATERIAL

MATERIAL	UNCOMPRESSED DEPTH			COMPRESSED DEPTH
	6 Inch	9 Inch	12 Inch	9 inch
Wood Chips	7	10	11	10
Double Shredded Bark Mulch	6	10	11	7
Engineered Wood Fibers	6	7	>12	6
Fine Sand	5	5	9	5
Coarse Sand	5	5	6	4
Fine Gravel	6	7	10	6
Medium Gravel	5	5	6	5
Shredded Tires**	10-12	N/A	N/A	N/A

\*\* This is data from tests conducted by independent testing laboratories on a 6 inch depth of uncompressed shredded tire samples produced by four manufacturers. The test reported critical heights, which varied from 10 feet to greater than 12 feet. It is recommended that persons seeking to install shredded tires as a protective surface request test data from the supplier showing the critical height of the material when it was tested in accordance with ASTM F1292.

Table 1 should be read as follows: If, for example, uncompressed wood chips are used at a minimum of 6 inches, the Critical Height is 7 feet. If 9 inches of uncompressed wood chips are used, the Critical Height is 10 feet. It should be noted that, for some materials, the Critical Height decreases when the material is compressed. It is recommended that a shock absorbing material should extend a minimum of 6 feet in all directions from the perimeter of stationary equipment such as climbers and slides. However, because children may deliberately jump from a moving swing, the shock absorbing material should extend in the front and rear of a swing a minimum distance of 2 times the height of the pivot point measured from a point directly beneath the pivot on the supporting structure.

This information is intended to assist in comparing the relative shock-absorbing properties of various materials. No particular material is recommended over another. However, each material is only effective when properly maintained. Materials should be checked periodically and replenished to maintain correct depth as determined necessary for your equipment. The choice of a material depends on the type and height of the playground equipment, the availability in your area, and its cost.

This information has been extracted from the CPSC publications "Playground Surfacing-Technical Information Guide" and "Handbook for Public Playground Safety." Copies of these reports can be obtained by sending a postcard to:

Office of Public Affairs  
U.S. Consumer Product Safety Commission  
Washington, D.C. 20207  
Toll-free Hotline: 1-800-638-2772 or at <http://www.cpsc.gov>

## **Megadeck Fort Universal Bundle 1**

Item No.	Part Number	Part Description	QTY.
MB1-1	17-4-00157	UNIVERSAL FORT MAINBEAM	4
MB1-2	16-4-00285	UNIVERSAL FORT TOP JOIST SB	1
MB1-3	16-4-00216	(L) GUSSET BRACKET	3
MB1-4	16-4-00217	(R) GUSSET BRACKET	3
MB1-5	16-4-00214	UNI. PC CORNER POST/ UNI. FORT UPRIGHT	3
MB1-6	16-4-00290	UNI. FORT WOOD ROOF CENTER POST	2
MB1-7	16-4-00283	UNIVERSAL FORT TRAPEZE ARM	1

## **Megadeck Fort Universal Bundle 2**

MB2-1	13-4-00076	UNI. FORT 4 HOLE FACIA	3
MB2-2	13-4-00069	UNI. 8 HOLE FACIA	6
MB2-3	13-4-00088	14 HOLE MEGADECK FACIA	2
MB2-4	12-4-00140	UNIVERSAL FILLER	3
MB2-5	13-4-00086	FORT PLAYHOUSE PANEL FACIA	1
MB2-6	12-4-00141	UNIVERSAL RAIL BOTTOM	2

## **7.0 Megadeck Fort - Bundle C.**

MBA-1	16-4-00301	136" FORT CORNER	4
MBA-2	16-4-00315	136" MEGADECK CORNER POST	2
MBA-3	13-4-00081	76" FORT WING MAINBEAM	1
MBA-4	16-4-00302	93 3/4" FORT WING SUPPORT	2
MBA-5	13-4-00084	164 5/8" FORT LOWER WING	1
MBA-6	13-4-00085	160 1/4" FORT UPPER WING	1
MBA-7	16-4-00299	110" FORT (L) LADDER LEG	1
MBA-8	16-4-00300	110" FORT (R) LADDER LEG	1
MBA-9	13-4-00079	UNIVERSAL FORT LADDER STEP	7

## **Universal Deck**

UD-1	12-4-00139	SMALL DECK BOARD	8
UD-2	13-4-00064	LARGE DECK BOARD	6
UD-3	12-4-00138	DECK RUNNERS	4
UD-4	13-4-00063	DECK SUPPORT	2

## **Mega Deck Decks**

MDD-1	13-4-00072	LARGE DECK BOARD	8
MDD-2	12-4-00154	SMALL DECK BOARD	2
MDD-3	12-4-00140	DECK BOARD	4

## **Universal Rail (Counts per Rail)**

Item No.	Part Number	Part Description	QTY.
RAIL-1	12-4-00140	UNIVERSAL RAIL TOP	1
RAIL-2	12-4-00141	UNIVERSAL RAIL BOTTOM	1
RAIL-3	15-4-00008	UNIVERSAL RAIL PICKET	5

## **7.0 Fort Rockwall Bundle**

RW-1	16-4-00308	107 1/2" FORT (R) ROCKWALL LADDER LEG	1
RW-2	16-4-00307	107 1/2" FORT (L) ROCKWALL LADDER LEG	1
RW-3	11-4-00138	UNI. FORT RW BOARD W/ ROPE HOLE	1
RW-4	11-4-00139	UNI. FORT RW BOARD BLANK	6
RW-5	11-4-00140	UNI. FORT RW BOARD W/ ROCK HOLES	10
RW-6	10-4-00266	UNI. SMALL RW BOARD BLANK	1
RW-7	16-4-00215	UNIVERSAL ROPE	1
RW-8	16-4-00218	UNIVERSAL ENTRAPMENT BLOCK	2

## **Mega Deck Fort Wood Roof Bundle**

WR-1	13-4-00078	UNIVERSAL WOOD ROOF SUPPORT	6
WR-2	64-7-00208	FORT WOOD ROOF FAN	3
WR-3	64-7-00209	FORT WOOD ROOF PANEL	3
WR-4	20-4-00007	UNIVERSAL WOOD ROOF PEAK FACIA	3
WR-5	64-7-00237	MEGADECK LEFT TOP DORMER WR PANEL	1
WR-6	64-7-00239	MEGADECK (R) TOP DORMER WR PANEL	1
WR-7	64-7-00238	MEGADECK (L) BOTTOM DORMER WR PANEL	1
WR-8	64-7-00240	MEGADECK (R) BOTTOM DORMER WR PANEL	1
WR-9	64-7-00241	MEGADECK (R) ANGLED WR PANEL	1
WR-10	64-7-00242	MEGADECK (L) ANGLED WR PANEL	1

## **Mega Deck Fort Standard Box**

MST-1	59-1-00013	TREE FROGS PLAQUE	1
MST-2	57-2-00004	1 1/4" PLAYGRIP SAFETY HANDLE	5
MST-3	57-2-00005	1 1/4" PLAYGRIP LADDER HANDLE	2
MST-4	56-1-00012	DUCTILE IRON SWING HANGER	2
MST-5	59-1-00011	SPRING CLIPS 10X100MM	2
MST-6	58-1-00013	FORT LADDER BRACKET	1

## **7.0 Mega Deck Fort Box A.(Multi- Color)**

Item No.	Part Number	Part Description	QTY.
BXA-1	37-1-00018	19" SHIP'S WHEEL-YELLOW	1
BXA-2	37-1-00021	TELESCOPE	1
BXA-3	60-1-00006	20" TRAPEZE BAR W/ 43" CHAIN- YELLOW	1

## **7.0 Fort Box Rockwall (Multi- Color)**

RWB-1	36-1-00023	LARGE ROCK- MULTI- COLOR	20
RWB-2	65-7-00017	14' YELLOW ROPE	1

## **7.0 Mega Deck Fort Box B.(Green)**

BXB-1	37-1-00019	19" SHIP'S WHEEL- GREEN	1
BXB-2	37-1-00021	TELESCOPE	1
BXB-3	60-1-00006	TRAPEZE BAR W/ RINGS- 43" CHAIN-YELLOW	1

## **7.0 Fort Box Rockwall (Green)**

RWG-1	36-1-00024	LARGE ROCK- GREEN	20
RWG-2	65-7-00017	14' YELLOW ROPE	1

## **Mega Deck Fort Hardware Bag**

MFH-1	40-1-00001	3/8" ACORN NUT	10
MFH-2	40-1-00002	1/2" ACORN NUT	15
MFH-3	40-1-00013	1/2" X 7" CARRIAGE BOLT	12
MFH-4	40-1-00020	1 5/8" COATED DECK SCREW	42
MFH-5	40-1-00022	2 1/2" COATED DECK SCREW	24
MFH-6	40-1-00026	3/8" HEX NUT	6
MFH-7	40-1-00028	1/2" HEX NUT	15
MFH-8	40-1-00043	3/8" X 5" HEX BOLT	6
MFH-9	40-1-00054	1/4" X 2" HEX LAG SCREW	14
MFH-10	40-1-00055	1/4" X 3" HEX LAG SCREW	4
MFH-11	40-1-00056	1/4" X 4 1/2" HEX LAG SCREW	68
MFH-12	40-1-00059	3/8" X 3 1/2" HEX LAG SCREW	92
MFH-13	40-1-00064	3/8" NYLON INSERT LOCKNUT	4
MFH-14	40-1-00069	#14 X 1 1/4" PAN PHILLIPS T/S	2
MFH-15	40-1-00070	#14 X 2" PAN PHILLIPS T/S	17
MFH-16	40-1-00073	3/8" SPLIT LOCKWASHER	10
MFH-17	40-1-00074	1/2" SPLIT LOCKWASHER	15
MFH-18	40-1-00078	5/16 X 3/8" 3 PRONG T-NUT	12
MFH-19	40-1-00081	1/4" USS FLATWASHER	103
MFH-20	40-1-00082	3/8" USS FLATWASHER	110
MFH-21	40-1-00083	1/2" USS FLATWASHER	24
MFH-22	40-1-00084	3/4" USS FLATWASHER	12
MFH-23	40-1-00105	5/16" X 1" HEX BOLT	12
MFH-24	40-1-00109	1/2" X 9" HEX BOLT	3
MFH-25	40-1-00115	3/8" X 5 1/2" CARRIAGE BOLT	6
MFH-26	41-1-00025	3/8" BOLT CUP	4

## **Mega Deck Fort 7.0 Hardware Bag**

Item No.	Part Number	Part Description	QTY.
7MH-1	40-1-00002	1/2" ACORN NUT PLATED	2
7MH-2	40-1-00028	1/2" HEX NUT	2
7MH-3	40-1-00056	1/4" X 4 1/2" HEX LAG SCREW	32
7MH-4	40-1-00059	3/8" X 3 1/2" HEX LAG SCREW	8
7MH-5	40-1-00061	3/8" X 5" HEX LAG SCREW	2
7MH-6	40-1-00074	1/2" SPLIT LOCKWASHER	2
7MH-7	40-1-00081	1/4" USS FLATWASHER	32
7MH-8	40-1-00082	3/8" USS FLATWASHER	10
7MH-9	40-1-00083	1/2" USS FLATWASHER	2
7MH-10	40-1-00084	3/4" USS FLATWASHER	2
7MH-11	40-1-00101	1/2" X 8 1/2" CARRIAGE BOLT	3
7MH-12	40-1-00114	1/2" X 5" CARRIAGE BOLT	2

## **7.0 Fort Rockwall Hardware Bag**

Item No.	Part Number	Part Description	QTY.
RWH-1	40-1-00067	1/4" X 1 1/2" PAN PHILLIPS M/S	40
RWH-2	40-1-00077	1/4" X 7/16" 4 PRONG T-NUT	40
RWH-3	40-1-00081	1/4" USS FLATWASHER	40
RWH-4	40-1-00061	3/8" X 5" HEX LAG SCREW	8
RWH-5	40-1-00082	3/8" USS FLATWASHER	8
RWH-6	40-1-00022	2 1/2" COATED DECK SCREW	72

## Megadeck Fort Bundle 1 of 2

MB1-1  
17-4-00157  
Universal Fort Mainbeam  
QTY. 4



MB1-2  
16-4-00285  
Uni. Fort Top Joist SB  
QTY. 1



MB1-3  
16-4-00216  
(L) Gusset Bracket  
QTY. 3



MB1-4  
16-4-00217  
(R) Gusset Bracket  
QTY. 3



MB1-5  
16-4-00214  
Universal Fort Upright  
QTY. 3



MB1-6  
16-4-00290  
Uni Fort Wood Roof Center Post  
QTY. 2



MB1-7  
16-4-00283  
Universal Fort Trapeze Arm  
QTY. 1



## Megadeck Fort Bundle 2 of 2

MB2-1  
13-4-00076  
Universal Fort 4- Hole Facia  
QTY. 3



MB2-2  
13-4-00069  
Universal 8 Hole Facia  
QTY. 6

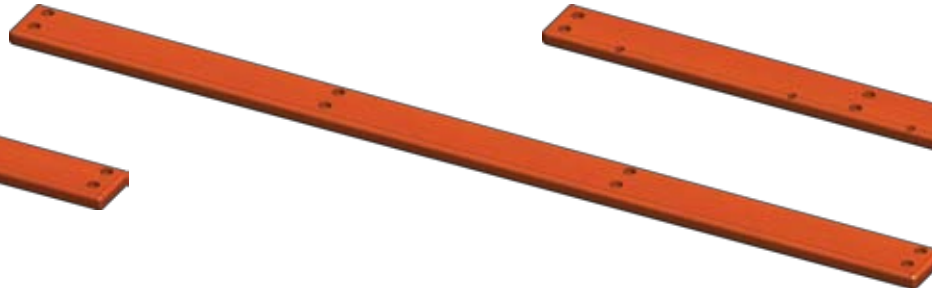

MB2-3  
13-4-00088  
14 Hole Megadeck Facia  
QTY. 2

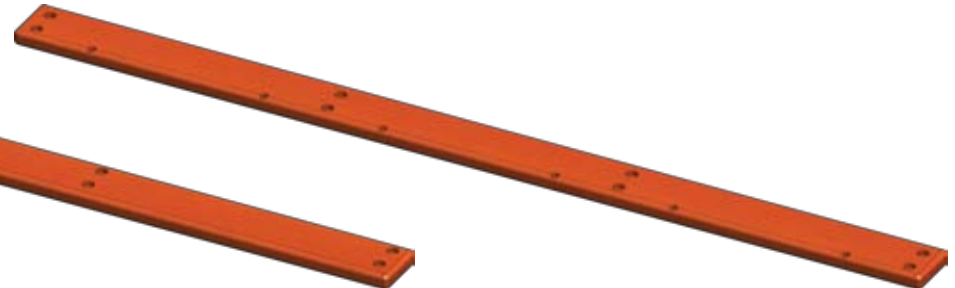

## Megadeck Fort Bundle 2 of 2 Cont.

MB2-4  
12-4-00140  
Universal Filler  
QTY. 3



MB2-5  
13-4-00086  
Fort Playhouse Panel Facia  
QTY. 1



MB2-6  
12-4-00141  
Universal Rail Bottom  
QTY. 2



## 7.0 Megadeck Fort Bundle C.

MBA-1  
16-4-00292  
128" Fort Corner Post  
QTY. 4



MBA-2  
16-4-00314  
128" Megadeck Corner Post  
QTY. 2



MBA-3  
13-4-00081  
76" Fort Wing Mainbeam  
QTY. 1



MBA-4  
16-4-00293  
93 3/4" Fort Wing Support  
QTY. 2



MBA-5  
13-4-00083  
164 5/8" Fort Lower Wing  
QTY. 1

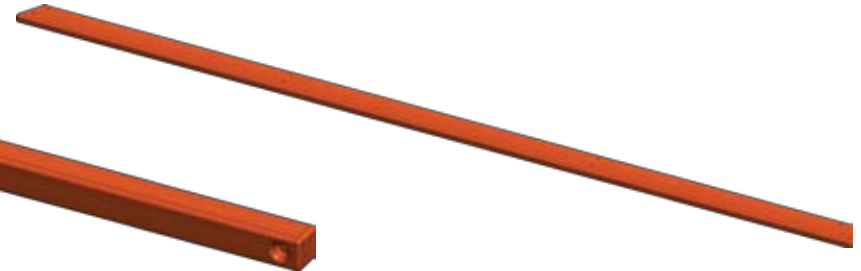



## 7.0 Megadeck Fort Bundle C. Cont.

MBA-6  
13-4-00082  
160 1/4" Fort Upper Wing  
QTY. 1



MBA-7  
16-4-00296  
110" Fort (L) Ladder Leg  
QTY. 1

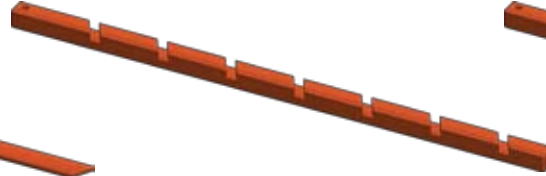

MBA-8  
16-4-00297  
110" Fort (R) Ladder Leg  
QTY. 1



MBA-9  
13-4-00079  
Universal Fort Ladder Step  
QTY. 8



## Universal Deck

UD-1  
12-4-00139  
Small Deck Board  
QTY. 8



UD-2  
13-4-00064  
Large Deck Board  
QTY. 6



UD-3  
12-4-00138  
Deck Runners  
QTY. 4



UD-4  
13-4-00063  
Deck Support  
QTY. 2



## Megadeck Decks

MDD-1  
13-4-00072  
Large Deck Board  
QTY. 8



MDD-2  
12-4-00154  
Small Deck Board  
QTY. 2



MDD-3  
12-4-00140  
Deck Support  
QTY. 4



## Universal Rail Bundle

RAIL-1  
12-4-00140  
Universal Rail Top  
QTY. 1



RAIL-2  
12-4-00141  
Universal Rail Bottom  
QTY. 1



RAIL-1  
15-4-00008  
Universal Rail Picket  
QTY. 5



## 7.0 Fort Rockwall

RW-1  
16-4-00306  
107 1/2" Fort (R) RW Ladder Leg  
QTY. 1



RW-2  
16-4-00305  
107 1/2" Fort (L) RW Ladder Leg  
QTY. 1



RW-3  
11-4-00138  
Uni. Fort RW Board w/ Rope Hole  
QTY. 1



RW-4  
11-4-00139  
Uni. Fort RW Board Blank  
QTY. 6



RW-5  
11-4-00140  
Uni. Fort RW Board w/ Rock Holes  
QTY. 10



RW-6  
10-4-00266  
Uni. Small RW Board Blank  
QTY. 1



## 6.4 Fort Rockwall Cont.

RW-7  
16-4-00216  
Universal Rope Block  
QTY. 1



RW-8  
16-4-00218  
Uni. Entrapment Block  
QTY. 2



## Megadeck Fort Wood Roof Bundle

WR-1  
13-4-00078  
Universal Wood Roof Support  
QTY. 6



WR-2  
64-7-00208  
Fort Wood Roof Fan  
QTY. 3

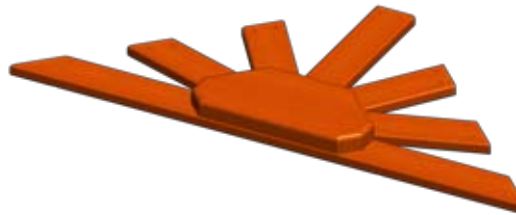

WR-3  
64-7-00209  
Fort Wood Roof Panel  
QTY. 3

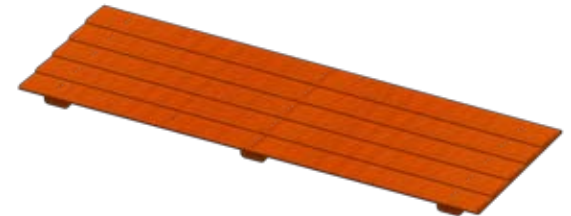

WR-4  
20-4-00007  
Universal Wood Roof Peak Facia  
QTY. 3



WR-5  
64-7-00237  
MD (L) Top Dormer WR Panel  
QTY. 1



WR-6  
64-7-00239  
MD (R) Top Dormer WR Panel  
QTY. 1



# Megadeck Fort Wood Roof Bundle Cont.

WR-7

64-7-00238

MD (L) Bottom Dormer WR Panel

QTY. 1



WR-8

64-7-00240

MD (R) Bottom Dormer WR Panel

QTY. 1



WR-9

64-7-00241

MD (R) Angled WR Panel

QTY. 1



WR-10

64-7-00242

MD (L) Angled WR Panel

QTY. 1



## MEGADECK FORT HARDWARE BAG

INSTALLER NOTE: (YOU MUST ASSEMBLE THIS PRODUCT IN ACCORDANCE WITH THESE ASSEMBLY INSTRUCTIONS. WHEN COMPLETE GIVE MANUAL TO OWNER.)

MFH-1  
40-1-00001  
3/8" Acorn Nut  
QTY. 10



MFH-2  
40-1-00002  
1/2" Acorn Nut  
QTY. 15



MFH-4  
40-1-00020  
1 5/8" Coated Deck Screw  
QTY. 42



MFH-5  
40-1-00022  
2 1/2" Coated Deck Screws  
QTY. 24



MFH-3  
40-1-00013  
1/2" x 7" Carriage Bolt  
QTY. 12

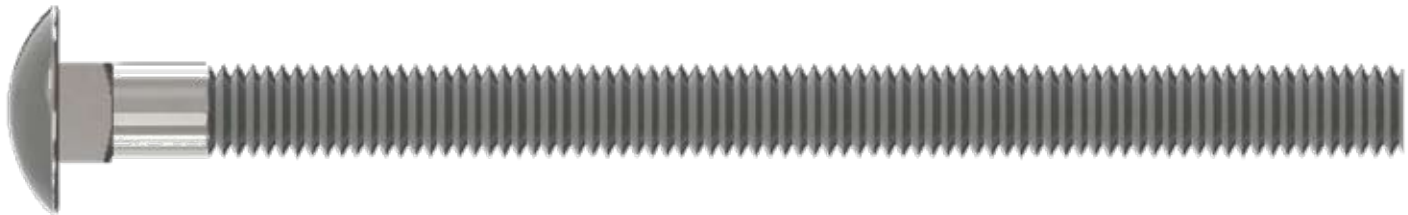

MFH-6  
40-1-00026  
3/8" Hex Nut  
QTY. 6



MFH-7  
40-1-00028  
1/2" Hex Nut  
QTY. 15



MFH-8  
40-1-00043  
3/8" x 5" Hex Bolt  
QTY. 6



MEASUREMENT TAKEN FROM BOTTOM OF BOLT HEAD TO THE BOTTOM OF BOLT



USE THE RULER TO MEASURE YOUR BOLTS AND SCREWS. HARDWARE VIEWS SHOWN ABOVE ARE 1:1 SCALE AND CAN BE USED TO MATCH HARDWARE SIZES.

# MEGADECK FORT HARDWARE BAG

**INSTALLER NOTE: (YOU MUST ASSEMBLE THIS PRODUCT IN ACCORDANCE WITH THESE ASSEMBLY INSTRUCTIONS. WHEN COMPLETE GIVE MANUAL TO OWNER.)**

MFH-9

40-1-00054

1/4" x 2" Hex Lag Screw  
QTY. 14



MFH-10

40-1-00055

1/4" x 3" Hex Lag Screw  
QTY. 4



MFH-11

40-1-00056

1/4" x 4 1/2" Hex Lag Screw  
QTY. 68



MFH-12

40-1-00059

3/8" x 3 1/2" Hex Lag Screw  
QTY. 92



MFH-13

40-1-00064

3/8" Nylon Insert Locknut  
QTY. 4



MFH-14

40-1-00069

#14 x 1 1/4" Pan Phillips T/S  
QTY. 2



MFH-15

40-1-00070

#14 x 2" Pan Phillips T/S  
QTY. 17



MFH-16

40-1-00073

3/8" Split Lockwasher  
QTY. 10



MFH-17

40-1-00074

1/2" Split Lockwasher  
QTY. 15



MFH-18

40-1-00078

5/16" x 3/8" 3 Prong T-Nut  
QTY. 12



MFH-19

40-1-00081

1/4" USS Flatwasher  
QTY. 103



**MEASUREMENT TAKEN FROM BOTTOM OF BOLT HEAD TO THE BOTTOM OF BOLT**

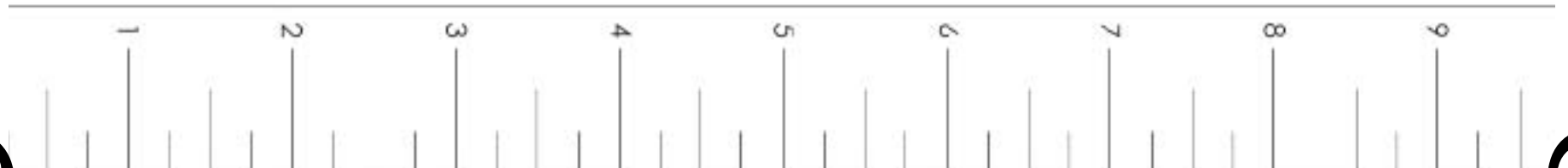

## MEGADECK FORT HARDWARE BAG

INSTALLER NOTE: (YOU MUST ASSEMBLE THIS PRODUCT IN ACCORDANCE WITH THESE ASSEMBLY INSTRUCTIONS. WHEN COMPLETE GIVE MANUAL TO OWNER.)

MFH-20  
40-1-00082

3/8" USS Flatwasher  
QTY. 110



MFH-21  
40-1-00083

1/2" USS Flatwasher  
QTY. 24

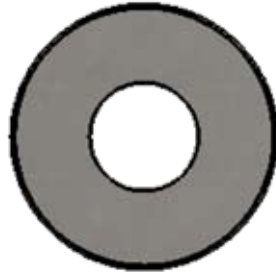

MFH-22  
40-1-00084

3/4" USS Flatwasher  
QTY. 12

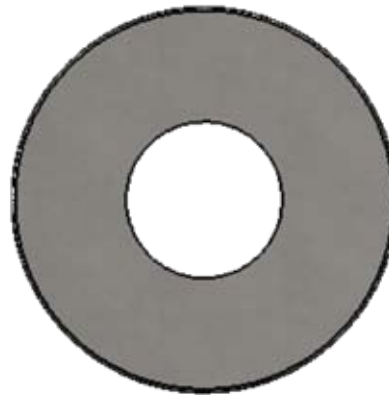

MFH-23  
40-1-00105

5/16" x 1" Hex Bolt  
QTY. 12



MFH-24  
40-1-00109

1/2" x 9" Hex Bolt  
QTY. 3



MEASUREMENT TAKEN FROM BOTTOM OF BOLT HEAD TO THE BOTTOM OF BOLT

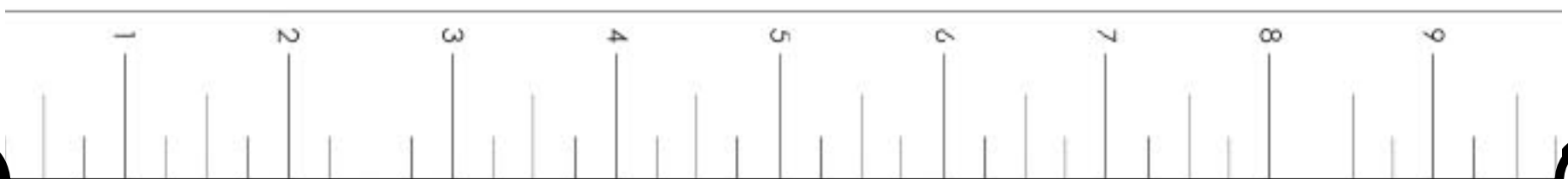



## MEGADECK FORT HARDWARE BAG

INSTALLER NOTE: (YOU MUST ASSEMBLE THIS PRODUCT IN ACCORDANCE WITH THESE ASSEMBLY INSTRUCTIONS. WHEN COMPLETE GIVE MANUAL TO OWNER.)

MFH-25

40-1-00115

3/8" x 5 1/2" Carriage Bolt  
QTY. 6

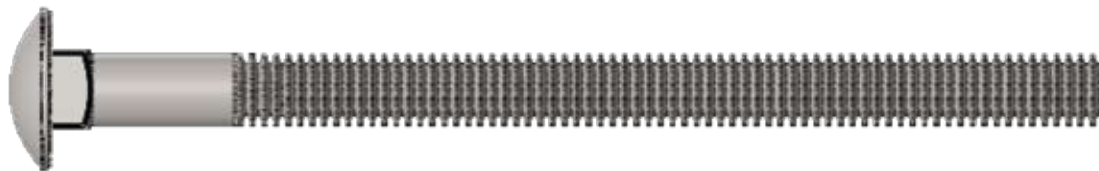

MFH-26

41-1-00025

3/8" Bolt Cup  
QTY. 4



### Megadeck 7.0 Hardware Bag

7MH-1

40-1-00002

1/2" Acorn Nut Plated  
QTY. 2



7MH-2

40-1-00028

1/2" Hex Nut  
QTY. 2



7MH-3

40-1-00056

1/4" x 4 1/2" Hex Lag Screw  
QTY. 32



7MH-4

40-1-00059

3/8" x 3 1/2" Hex Lag Screw  
QTY. 8



MEASUREMENT TAKEN FROM BOTTOM OF BOLT HEAD TO THE BOTTOM OF BOLT

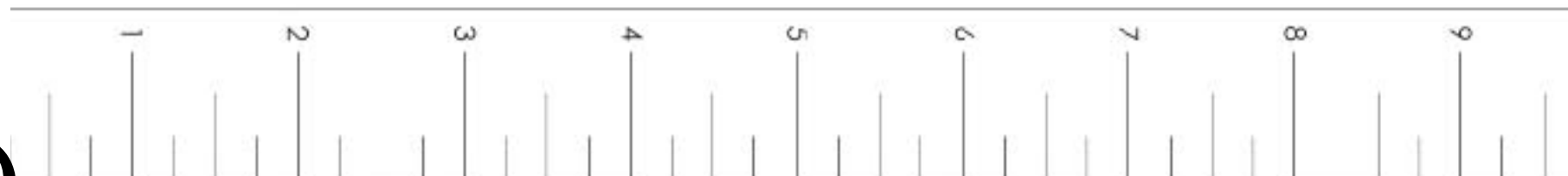



## MEGADECK 7.0 HARDWARE BAG

INSTALLER NOTE: (YOU MUST ASSEMBLE THIS PRODUCT IN ACCORDANCE WITH THESE ASSEMBLY INSTRUCTIONS. WHEN COMPLETE GIVE MANUAL TO OWNER.)

7MH-5

40-1-00061

3/8" x 5" Hex Lag Screw

QTY. 2



7MH-6

40-1-00074

1/2" Split Lockwasher

QTY. 2



7MH-10

40-1-00084

3/4" USS Flatwasher

QTY. 2

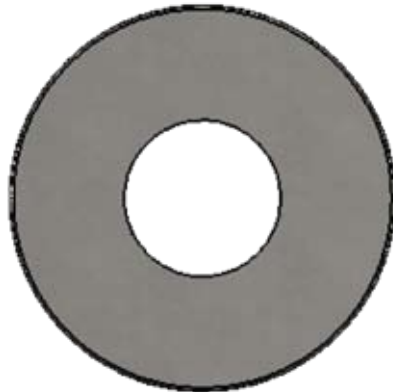

7MH-7

40-1-00081

1/4" USS Flatwasher

QTY. 32



7MH-8

40-1-00082

3/8" USS Flatwasher

QTY. 10

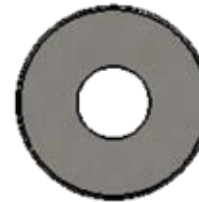

7MH-9

40-1-00083

1/2" USS Flatwasher

QTY. 2

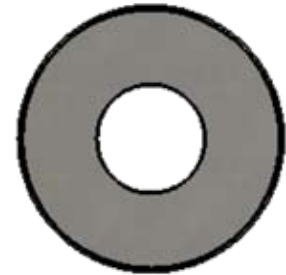

MEASUREMENT TAKEN FROM BOTTOM OF BOLT HEAD TO THE BOTTOM OF BOLT

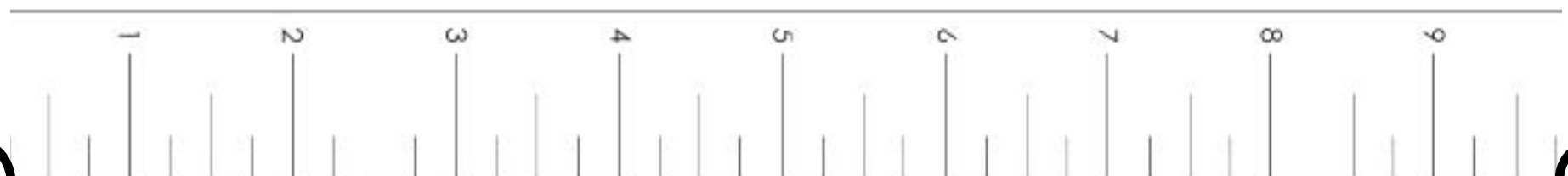

## MEGADECK 7.0 HARDWARE BAG

INSTALLER NOTE: (YOU MUST ASSEMBLE THIS PRODUCT IN ACCORDANCE WITH THESE ASSEMBLY INSTRUCTIONS. WHEN COMPLETE GIVE MANUAL TO OWNER.)

7MH-11

40-1-00101

1/2" x 8 1/2" Carriage Bolt

QTY. 3

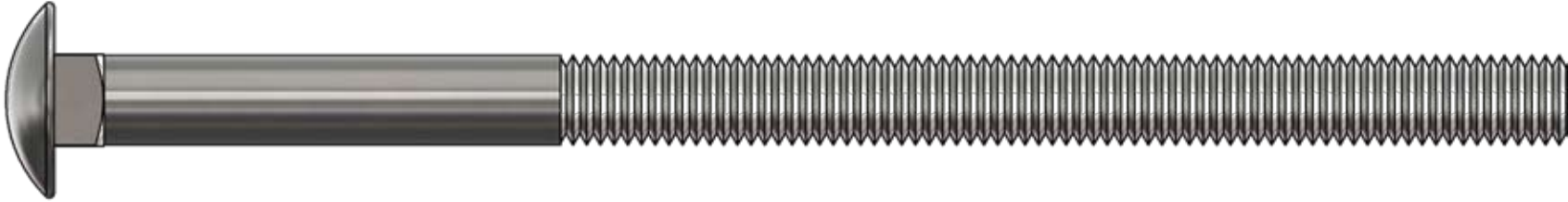

7MH-12

40-1-00114

1/2" x 5" Carriage Bolt

QTY. 2

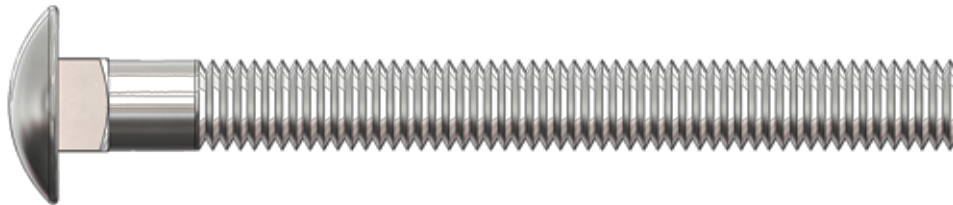

MEASUREMENT TAKEN FROM BOTTOM OF BOLT HEAD TO THE BOTTOM OF BOLT



## 7.0 FORT ROCKWALL HARDWARE BAG

INSTALLER NOTE: (YOU MUST ASSEMBLE THIS PRODUCT IN ACCORDANCE WITH THESE ASSEMBLY INSTRUCTIONS. WHEN COMPLETE GIVE MANUAL TO OWNER.)

RWH-1  
40-1-00067

1/4" x 1 1/2" Pan Phillips M/S  
QTY. 40



RWH-2  
40-1-00077

1/4" x 7/16" 4 Prong T-Nut  
QTY. 40



RWH-3  
40-1-00081

1/4" USS Flatwasher  
QTY. 40

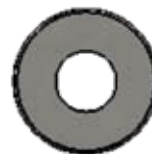

RWH-5  
40-1-00082

3/8" USS Flatwasher  
QTY. 8



RWH-4  
40-1-00061

3/8" x 5" Hex Lag Screw  
QTY. 8



RWH-6  
40-1-00022

2 1/2" Coated Deck Screw  
QTY. 72

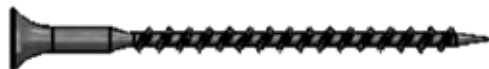

MEASUREMENT TAKEN FROM BOTTOM OF BOLT HEAD TO THE BOTTOM OF BOLT

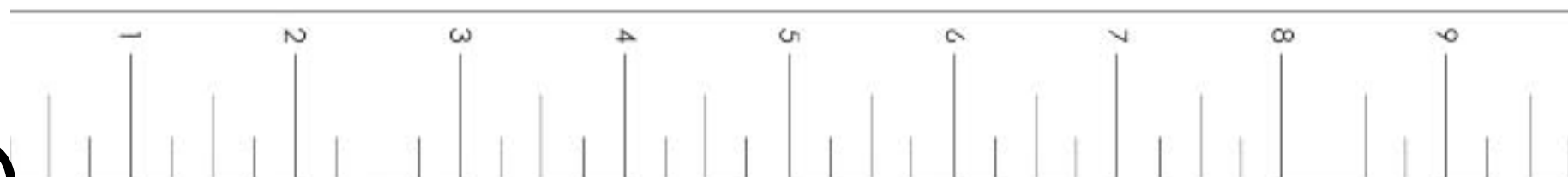

## Megadeck Fort- Standard Box

MST-1

59-1-00013

Tree Frogs Plaque

QTY. 1



MST-5

59-1-00011

Spring Clips 10 x 100mm

QTY. 2



MST-2

57-2-00004

1 1/4" Playgrip Safety Handle

QTY. 5

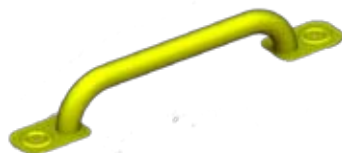

MST-6

58-1-00013

Fort Ladder Bracket

QTY. 1

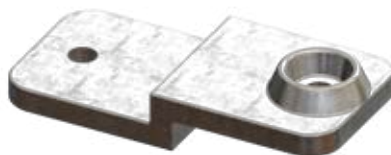

MST-3

57-2-00005

1 1/4" Playgrip Ladder Handle

QTY. 2

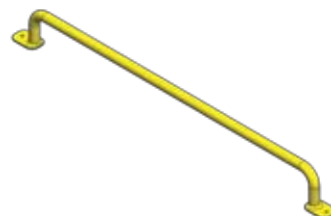

MST-4

56-1-00012

Ductile Iron Swing Hanger

QTY. 2



### 6.4 Megadeck Fort Box A. & B.

BXA-1

37-1-00018

19" Ship's Wheel- Yellow

QTY. 1



BXB-1

37-1-00019

19" Ship's Wheel- Green

QTY. 1



BXA-2 & BXB-2

37-1-00021

Telescope

QTY. 1



BXA-3 & BXB-3

60-1-00006

20" Trapeze Bar w/ 43 Chain- Yellow

QTY. 1



## 7.0 Fort Rockwall Box (Multi- Color and Green)

RWB-1

36-1-00023

Large Rock- (Multi Color)

QTY. 20



RWG-1

36-1-00024

Large Rock- Green

QTY. 20



RWB-2 & RWG-2

65-7-00017

18' Yellow Rope

QTY. 1



# LADDER ASSEMBLY

## PARTS NEEDED

MBA-7- 110" Fort (L) Ladder Leg-	(1)
MBA-8- 110" Fort (R) Ladder Leg-	(1)
MBA-9- Universal Fort Ladder Step-	(8)
RW-5- Rockwall Board w/ Rock Holes-	(10)
RWB-1 or RWG-1- Rockwall Rocks-	(20)

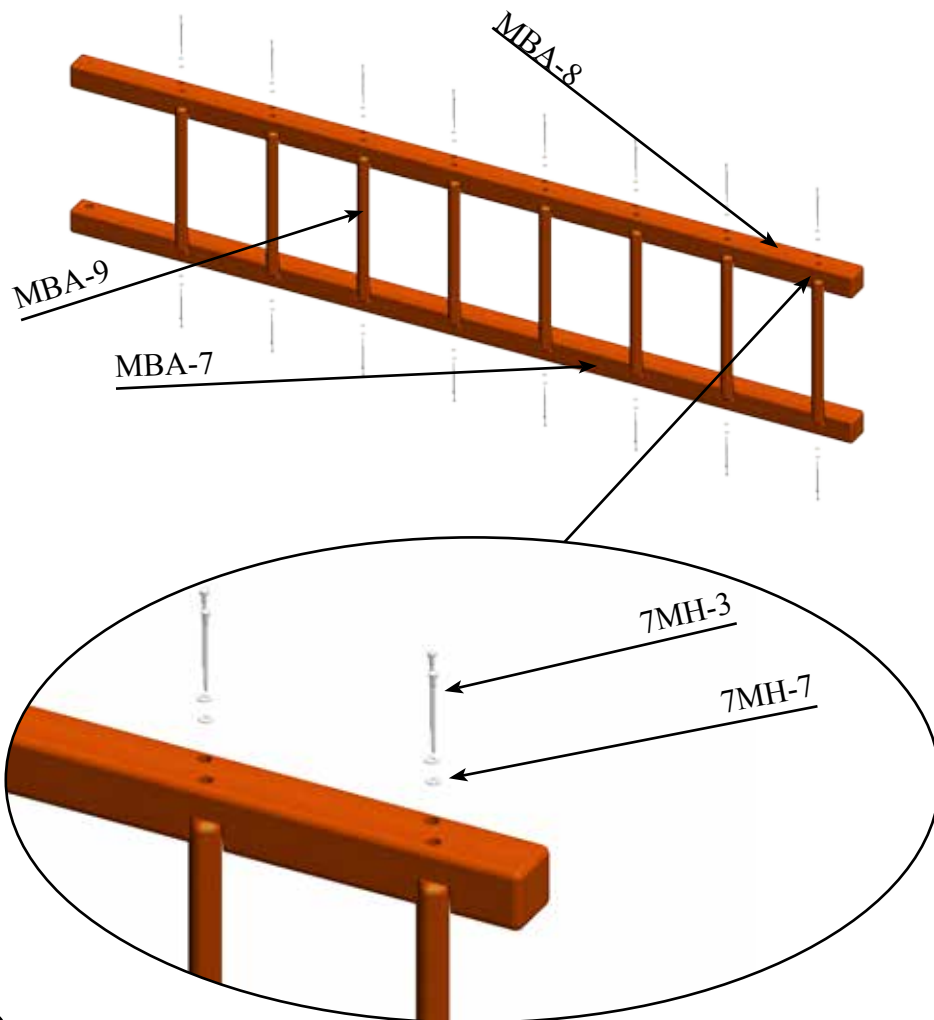

# RW BOARD

## HARDWARE NEEDED

RWH-1- 1/4" x 1 1/2" Pan Phillips M/S-	(40)
7MH-3- 1/4" x 4 1/2" Hex Lag Screw-	(32)
7MH-7- 1/4" USS Flatwasher-	(32)
RWH-2- 1/4" 4 Prong T-Nut-	(40)
RWH-3- 1/4" USS Flatwasher-	(40)

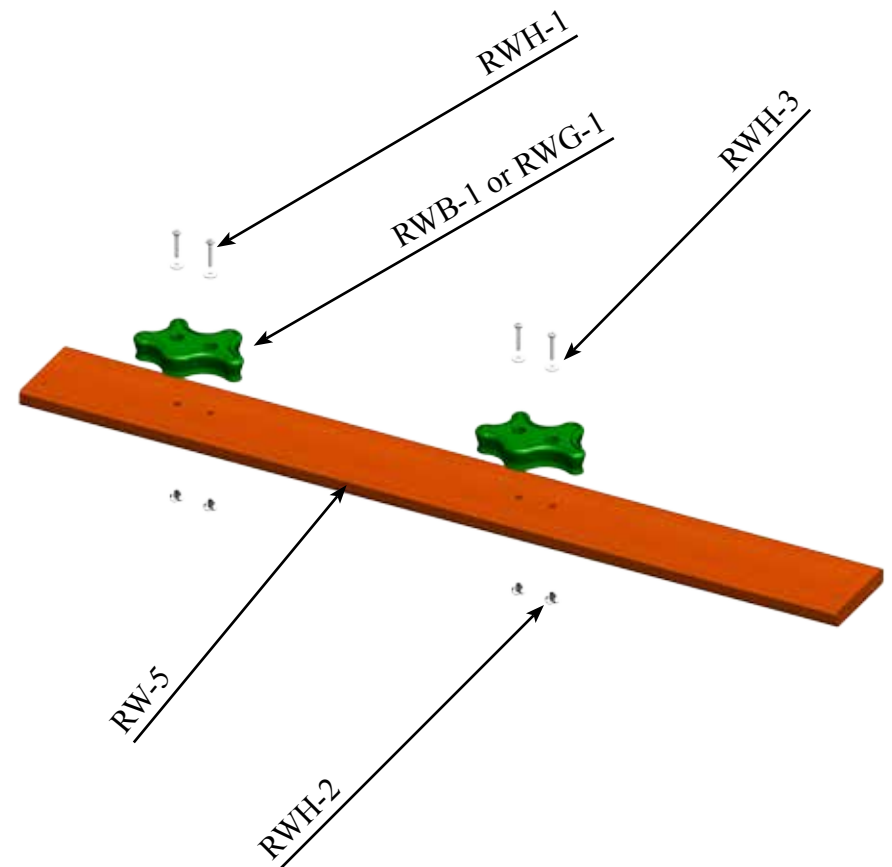

# RW ASSEMBLY

## PARTS NEEDED

RW-1- 107 1/2" Fort (R) RW Ladder Leg-	(1)	RW-2- 107 1/2" Fort (L) RW Ladder Leg-	(1)
RW-3- Rockwall Board w/ Rope Hole-	(1)	RW-4- RW Board Blank-	(6)
RW-5- Rockwall Board w/ Rocks-	(10)	RW-6- Small RW Board Blank-	(1)
MDD-1- Large Deck Board-	(8)	MDD-2- Small Deck Board-	(2)
MDD-3- Deck Runners-	(4)		

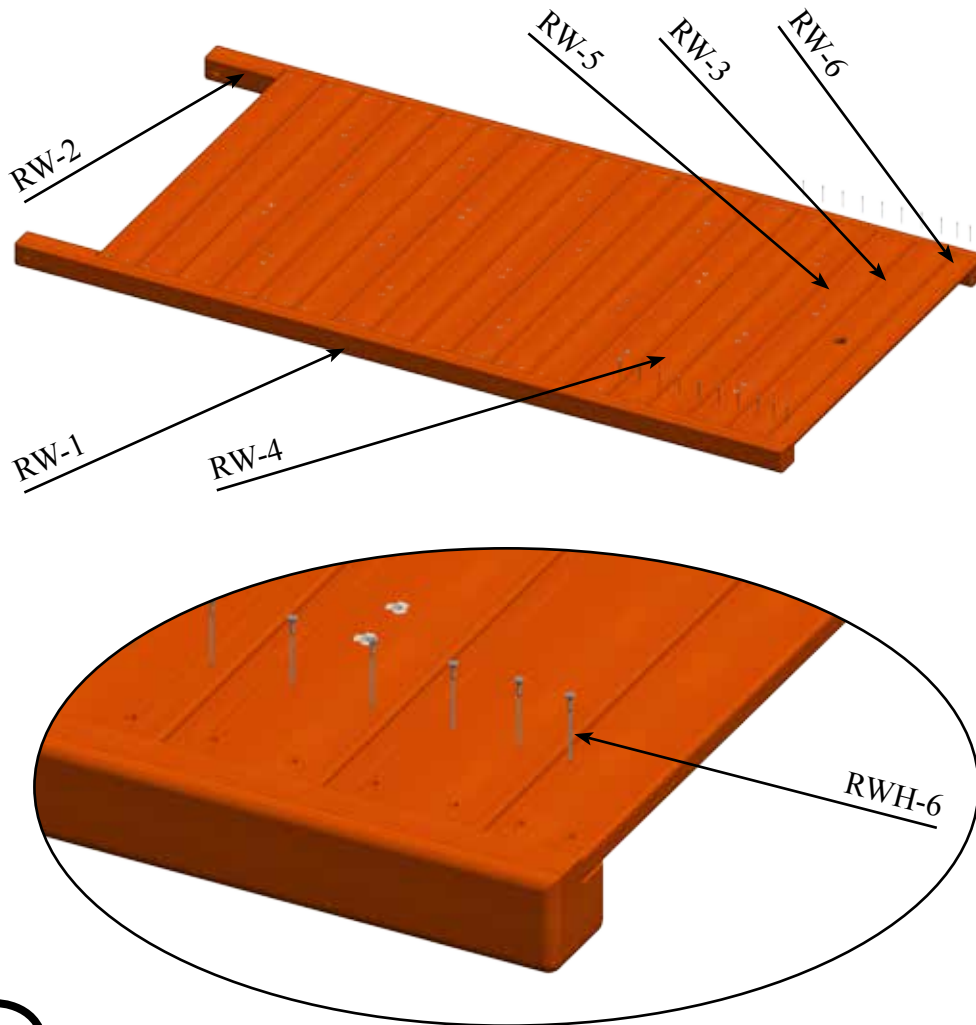

# MEGADECK DECKS

## HARDWARE NEEDED

RWH-6- 2 1/2" Coated Deck Screw-	(72)
MDD-4- 2 1/2" Coated Deck Screw-	(40)

REPEAT STEP FOR 2 MEGADECK DECKS

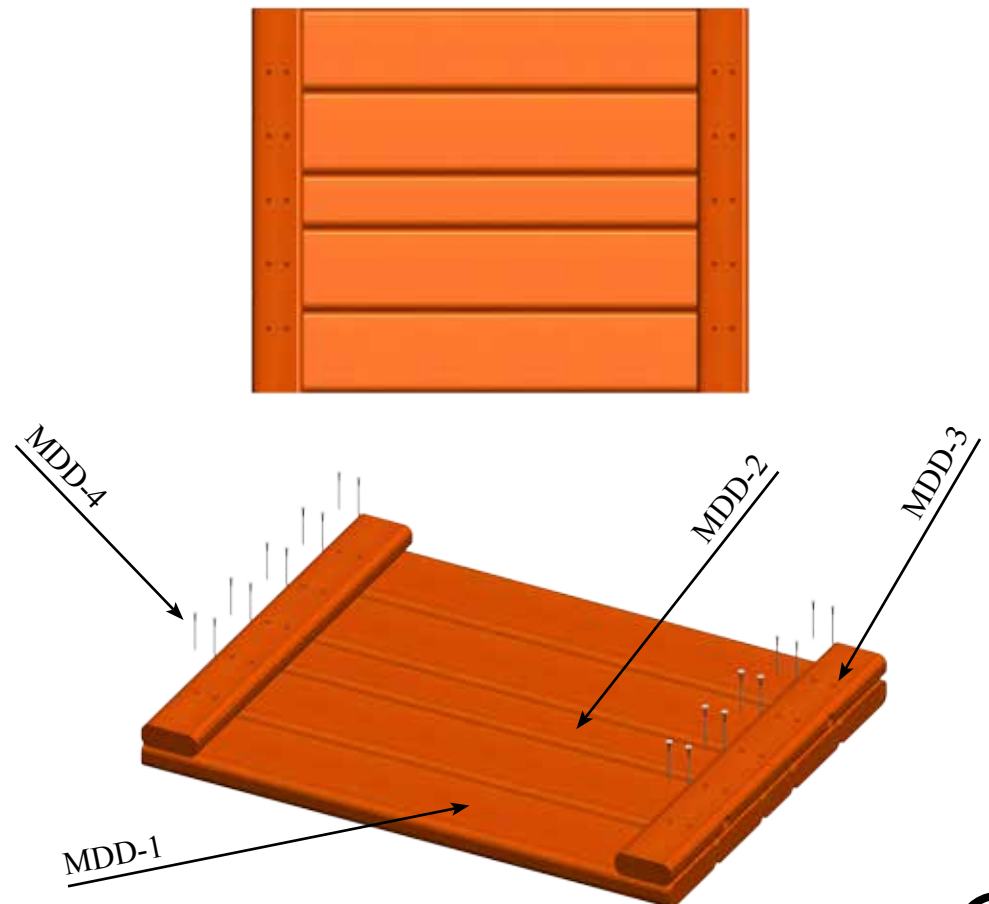



# UNIVERSAL DECKS

## PARTS NEEDED

UD-1- Small Deck Board-	(8)	UD-2- Large Deck Board-	(6)
UD-3- Deck Runners-	(4)	UD-4- Deck Support-	(2)
RAIL-1- Universal Rail Top-	(1)	RAIL-2- Universal Rail Bottom-	(1)
RAIL-3- Universal Rail Picket-	(5)		

REPEAT STEP FOR 2 UNIVERSAL DECKS

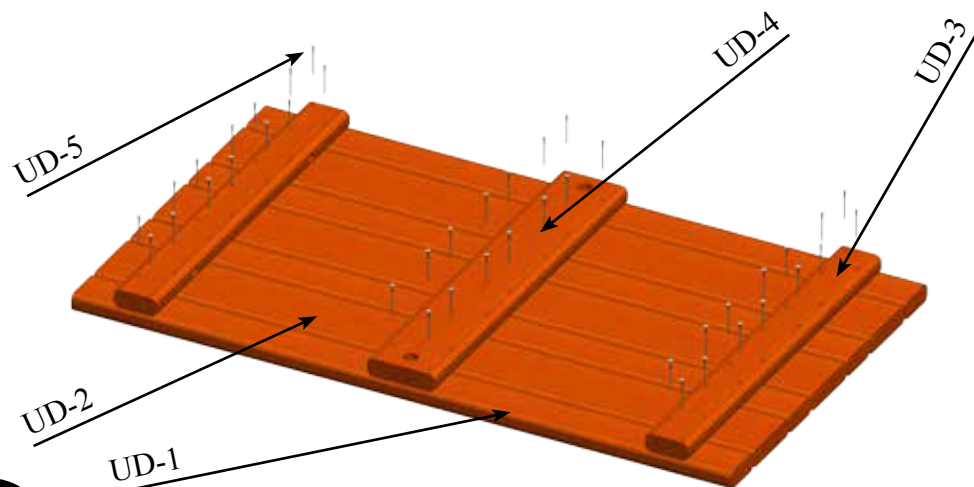
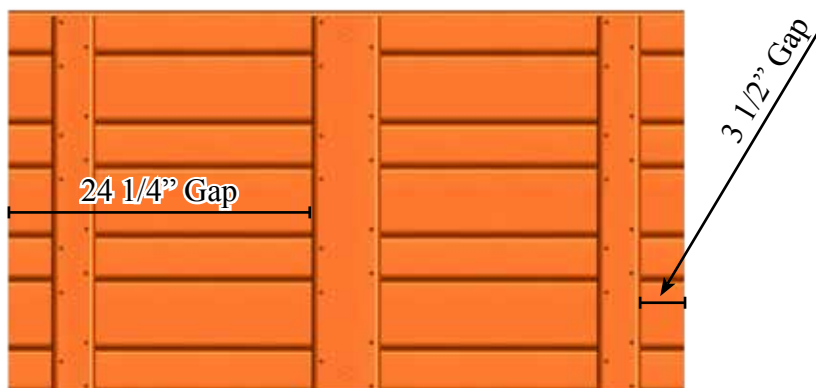

# RAIL ASSEMBLY

## HARDWARE NEEDED

UD-5- 2 1/2" Coated Deck Screws-	(42)
RAIL-4- 2 1/2" Coated Deck Screw-	(20) (PER RAIL)

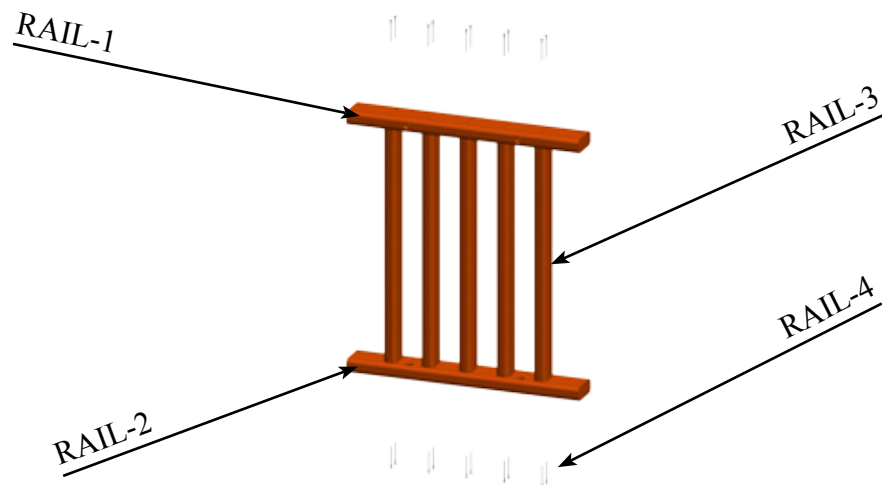
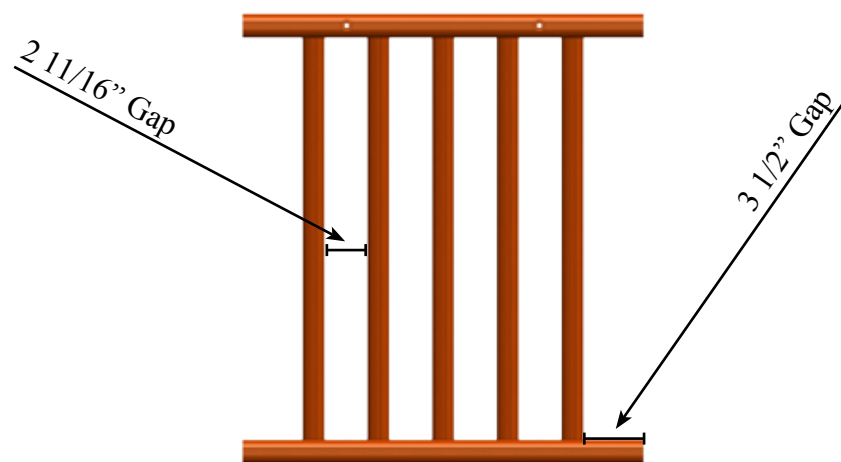



# (L) SIDE MEGADECK WALL

## PARTS NEEDED

MBA-1- 136" Fort Corner Post-	(2)
MBA-2- 136" Megadeck Corner Post-	(1)
MB2-2- Universal 8 Hole Facia-	(3)
MB2-3- 14 Hole Megadeck Facia-	(1)

## HARDWARE NEEDED

MFH-12- 3/8" x 3 1/2" Hex Lag Screw-	(24)
MFH-20- 3/8" USS Flatwasher-	(24)

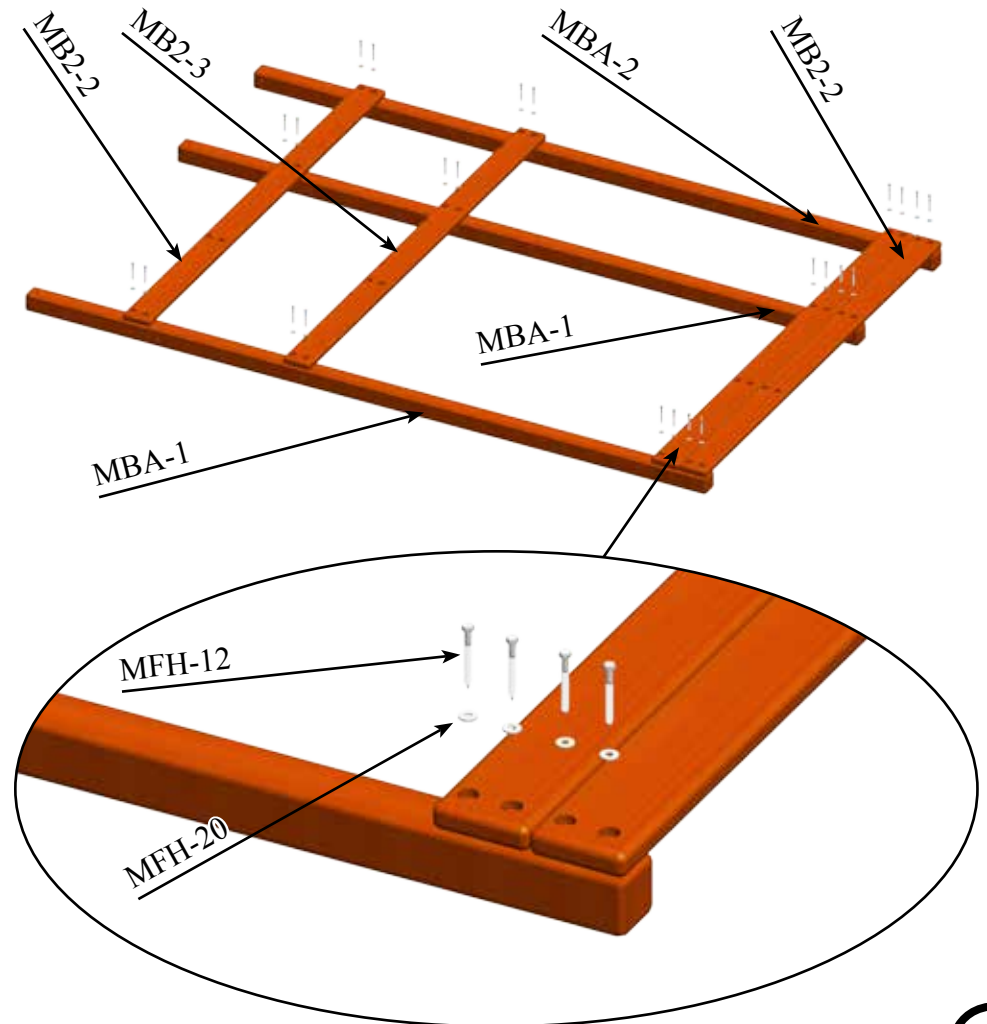
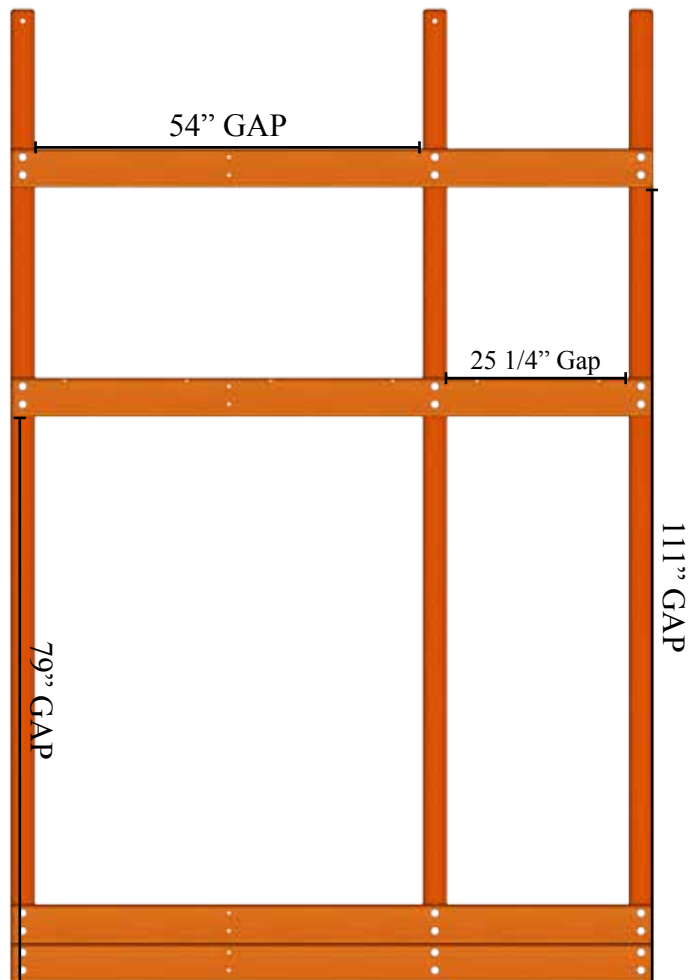

## (L) SIDE MEGADECK WALL

## (R) SIDE MEGADECK WALL

### HARDWARE NEEDED

MFH-18- 5/16" 4 Prong T-Nut-	(6)
MFH-20- 3/8" USS Flatwasher-	(6)
MFH-23- 5/16" x 1" Hex Bolt-	(6)

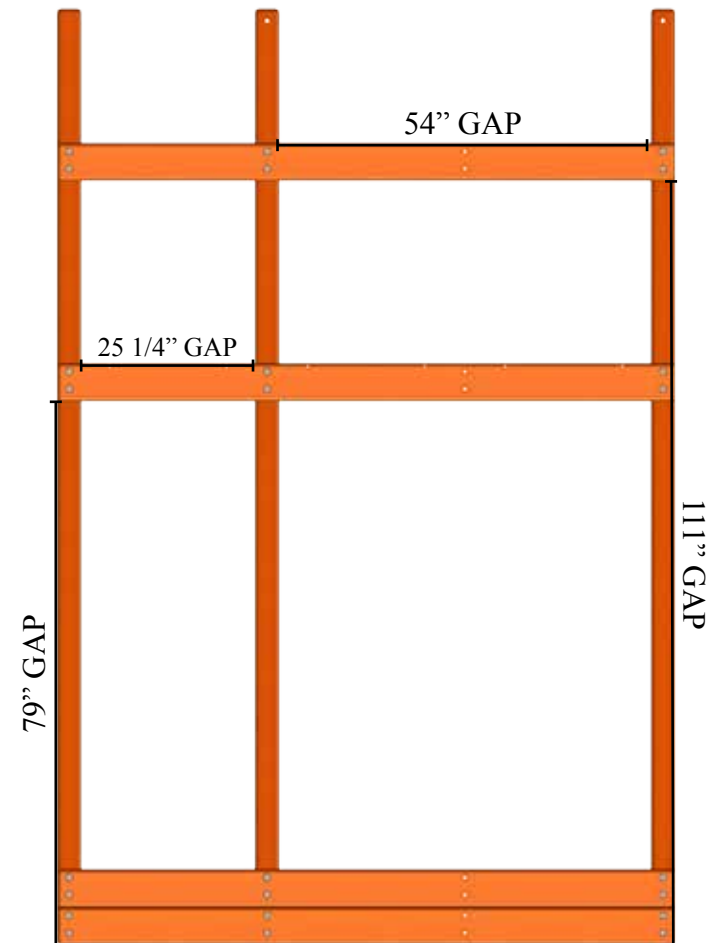
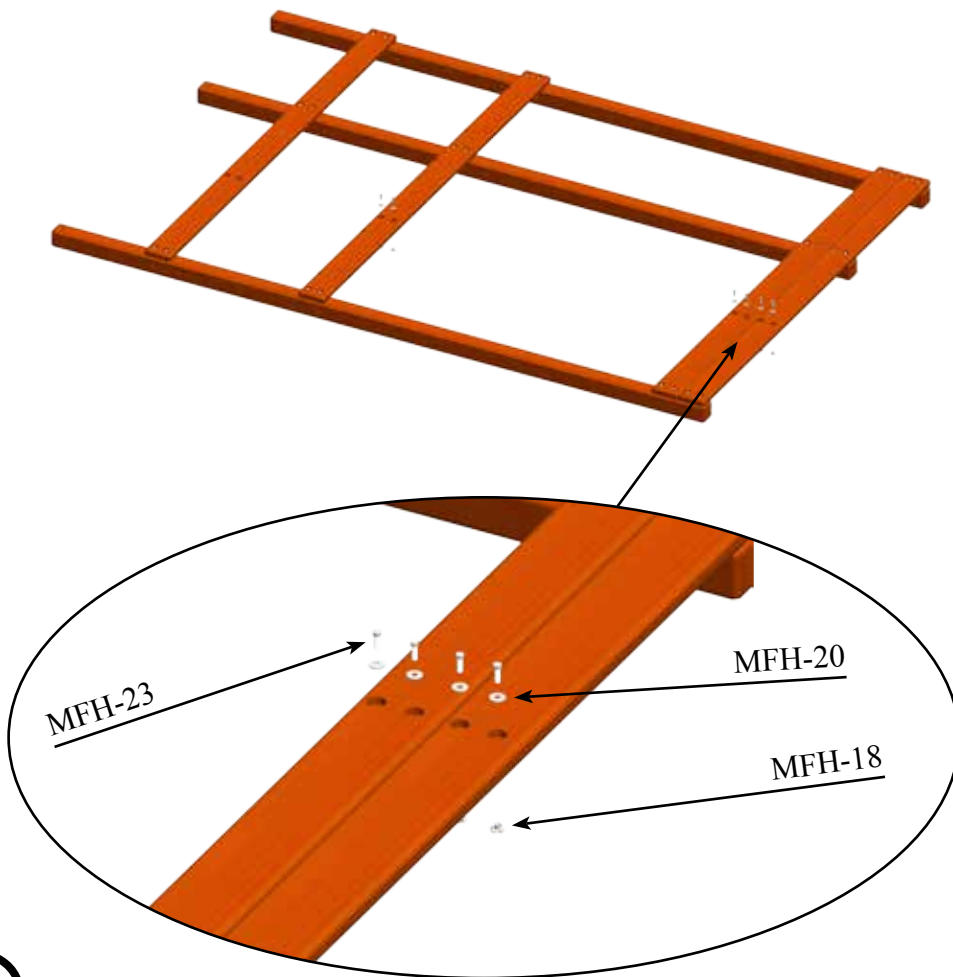

# (R) SIDE MEGADECK WALL

## PARTS NEEDED

MBA-1- 136" Fort Corner Post-	(2)
MBA-2- 136" Megadeck Fort Corner Post-	(1)
MB2-2- Universal 8 Hole Facia-	(3)
MB2-3- Megadeck 14 Hole Facia-	(1)

## HARDWARE NEEDED

MFH-12- 3/8" x 3 1/2" Hex Lag Screw-	(24)
MFH-20- 3/8" USS Flatwasher-	(30)
MFH-18- 5/16" 4 Prong T-Nut-	(6)
MFH-23- 5/16" x 1" Hex Bolt-	(6)

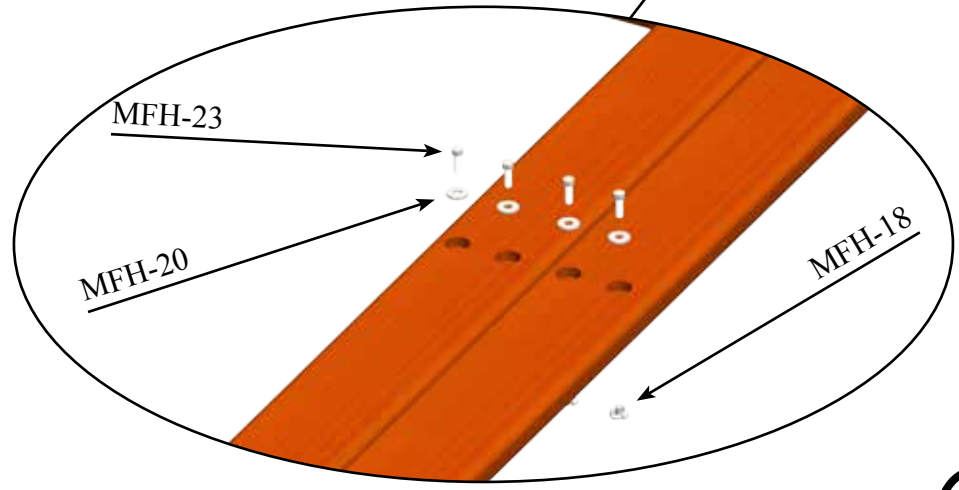
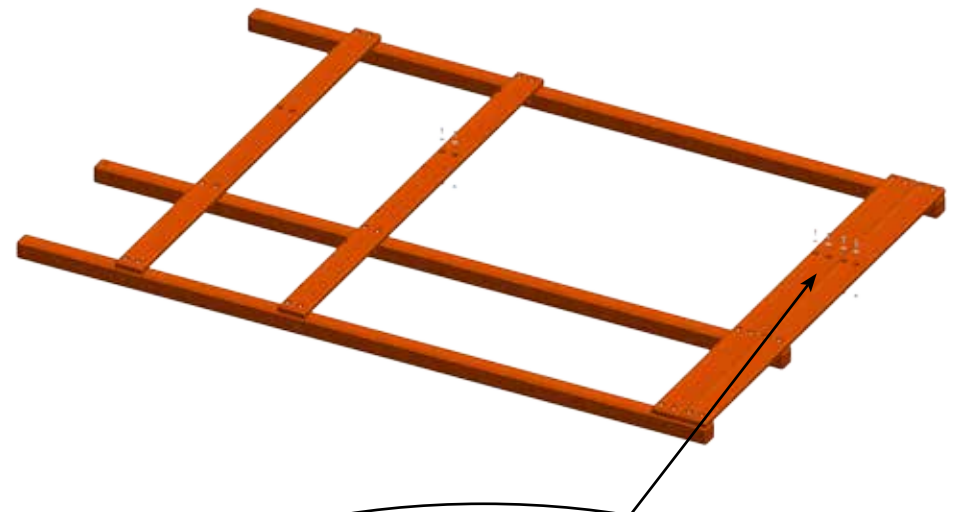
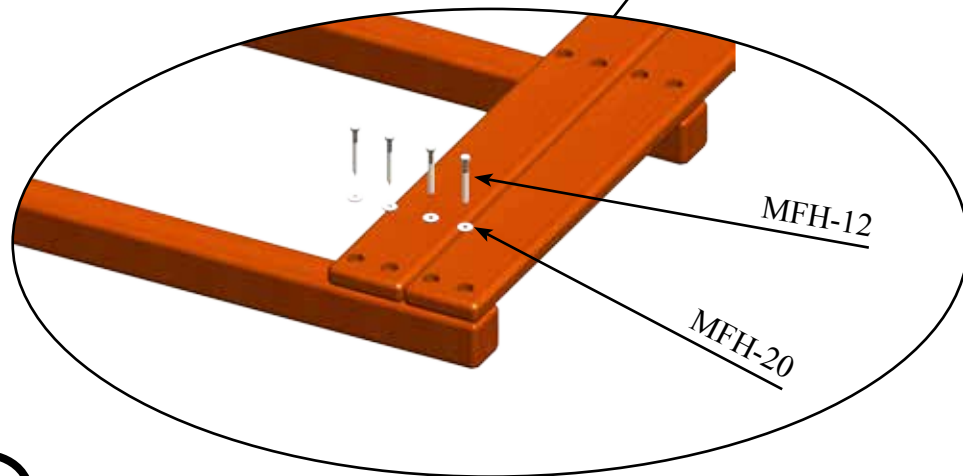
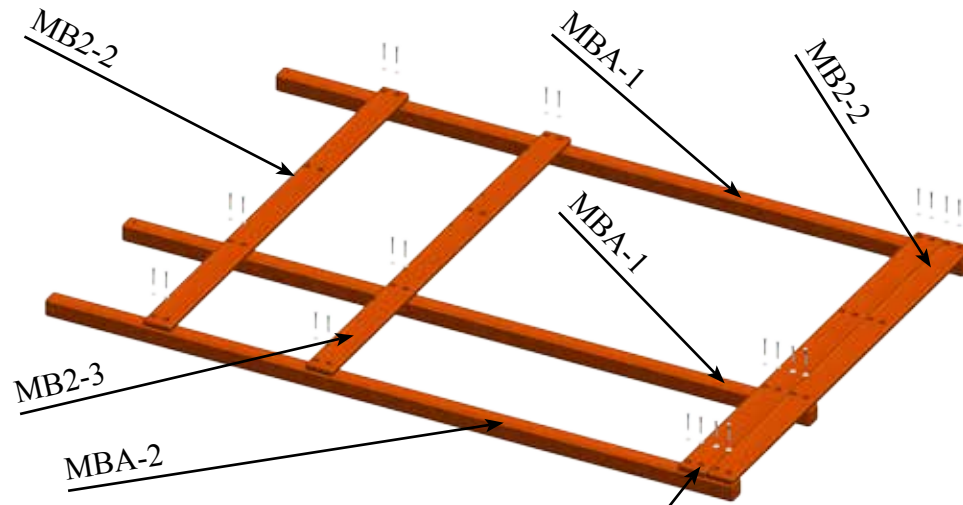

# MAIN ASSEMBLY

## PARTS NEEDED

MB2-1- Universal Fort 4 Hole Facia-	(2)
MBA-5- 164 5/8" Fort Lower Wing-	(1)
MBA-6- 160 1/4" Fort Upper Wing-	(1)

## HARDWARE NEEDED

MFH-12- 3/8" x 3 1/2" Hex Lag Screw-	(16)
MFH-20- 3/8" USS Flatwasher-	(16)

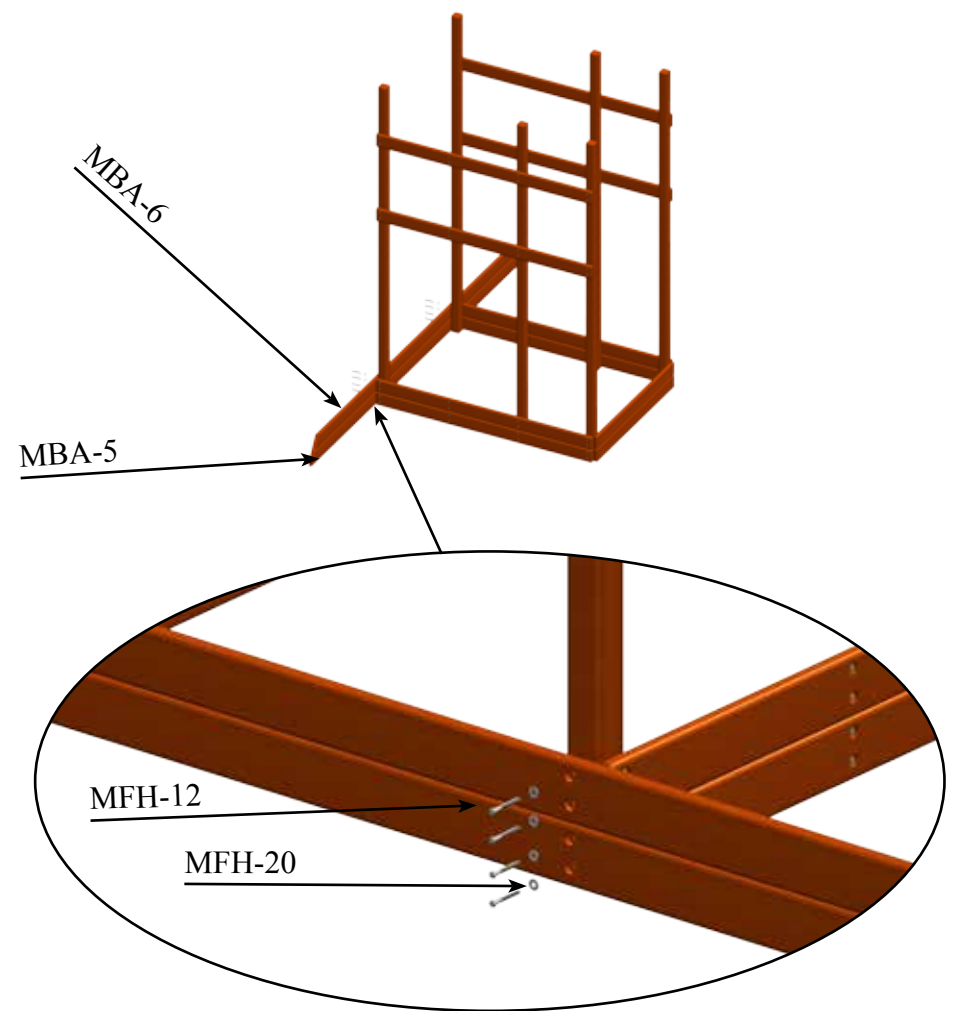
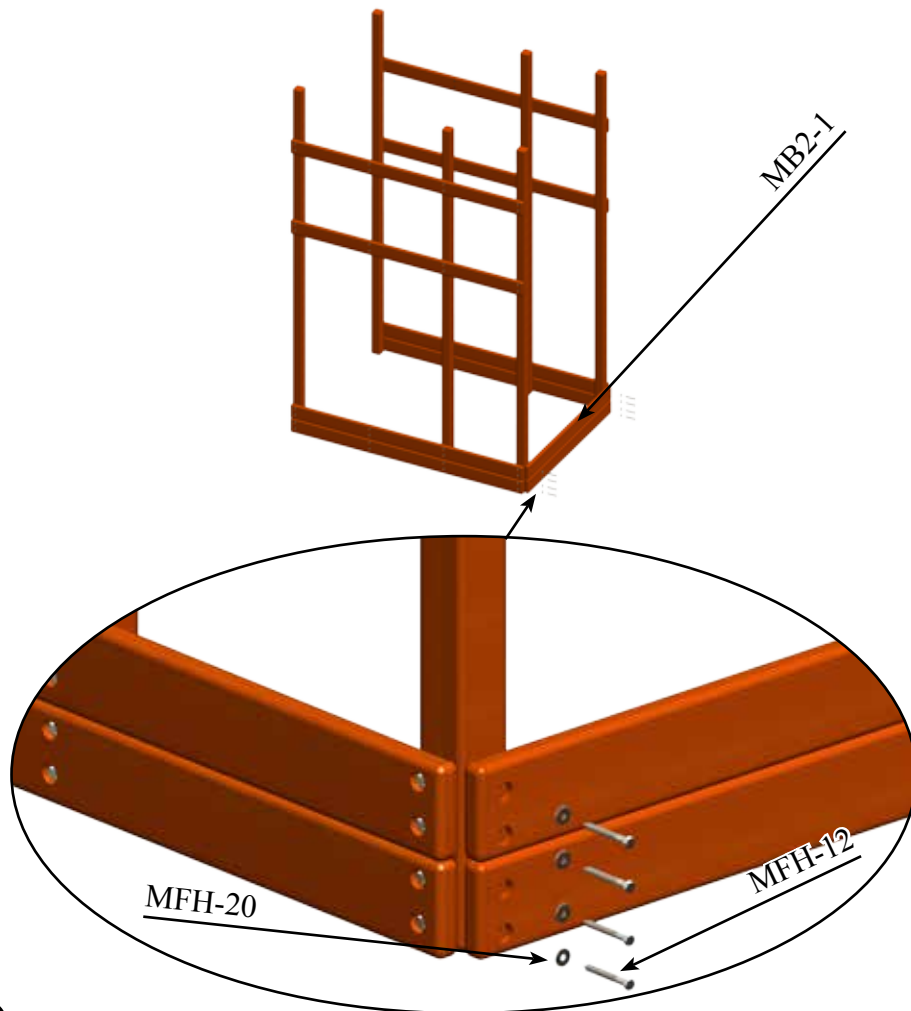

# MAIN ASSEMBLY

## PARTS NEEDED

MB1-1- Universal Fort Mainbeam- (3)

MFH-2- 1/2" Acorn Nut-  
MFH-17- 1/2" Split Lockwasher-  
MFH-22- 3/4" USS Flatwasher-  
MFH-24- 1/2" x 9" Hex Bolt-

## HARDWARE NEEDED

(4)	MFH-7- 1/2" Hex Nut-	(4)
(4)	MFH-21- 1/2" USS Flatwasher-	(6)
(2)	MFH-3- 1/2" x 7" Carriage Bolt-	(2)
(2)		

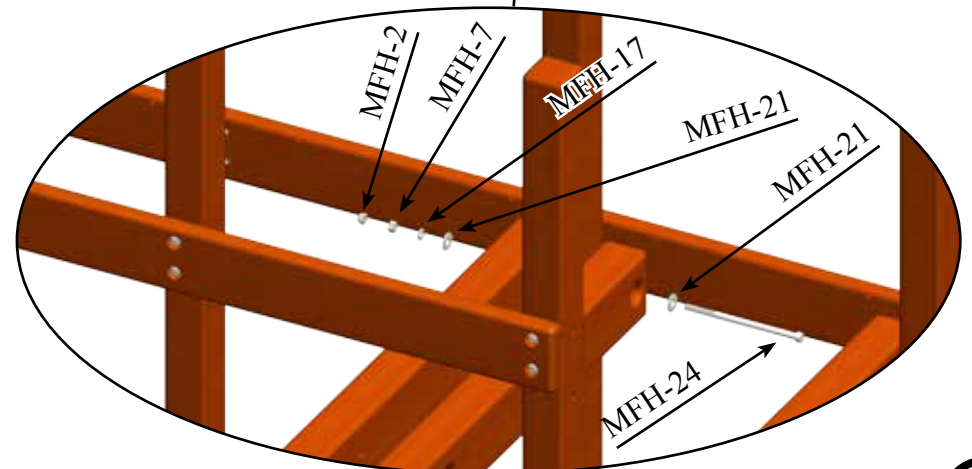
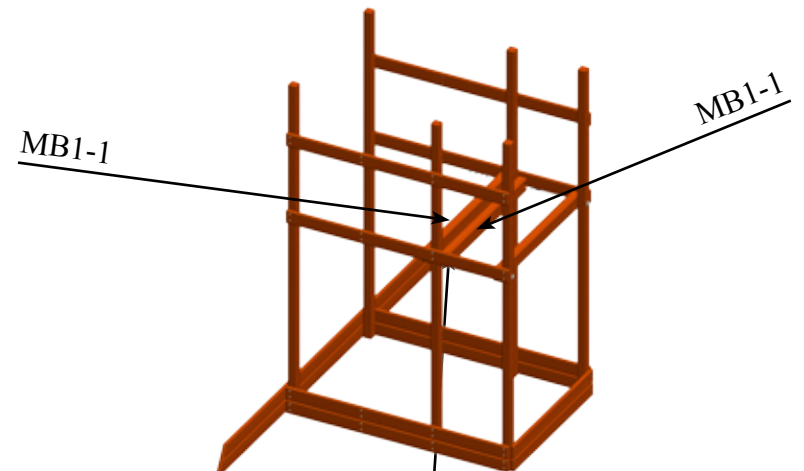
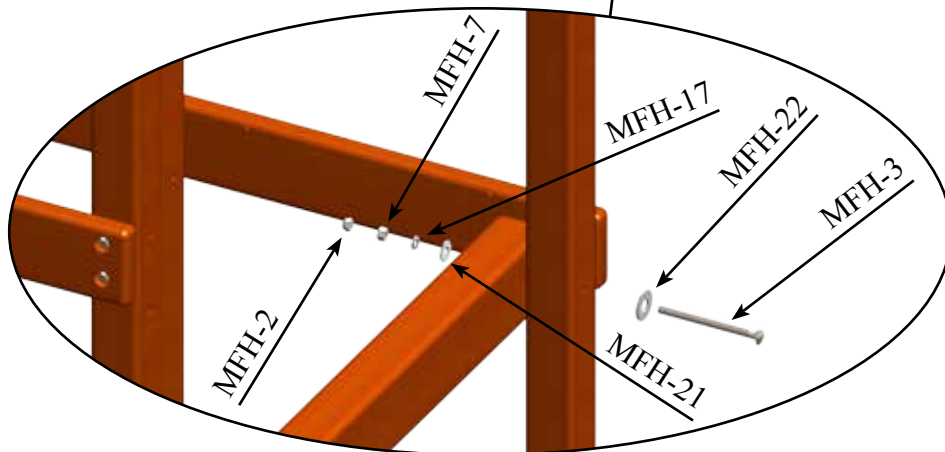
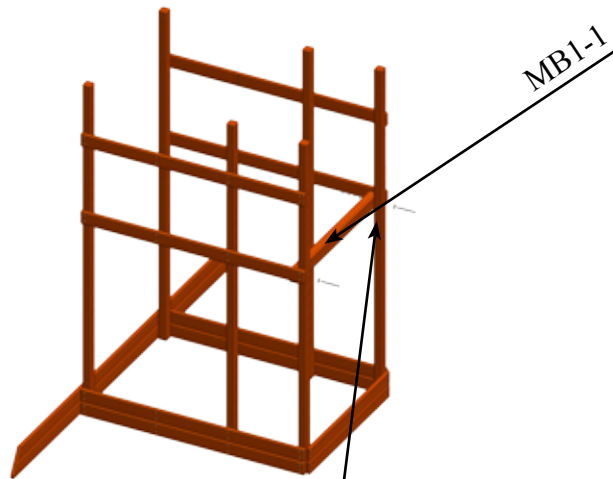

# MAIN ASSEMBLY

## PARTS NEEDED

MB1-1- Universal Fort Mainbeam-	(1)
MB1-3- (L) Gusset Bracket-	(1)
MB1-4- (R) Gusset Bracket-	(1)

## HARDWARE NEEDED

MFH-12- 3/8" x 3 1/2" Hex Lag Screw-	(4)
MFH-20- 3/8" USS FLatwasher-	(4)
7MH-10- 3/4" USS Flatwasher-	(2)
7MH-11- 1/2" x 8 1/2" Carriage Bolt-	(2)

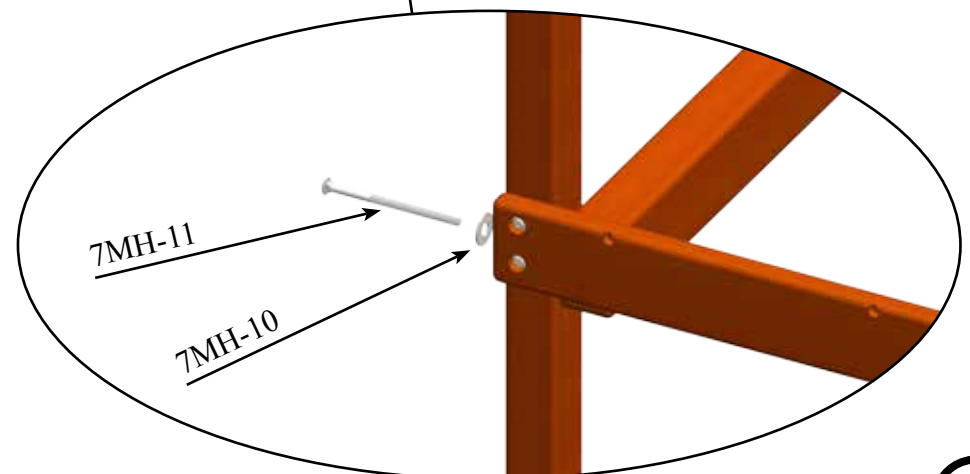
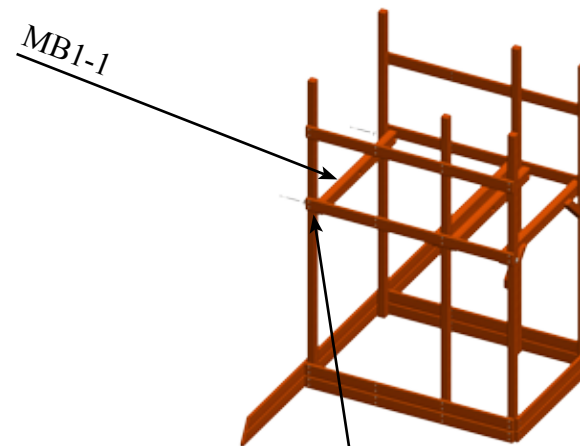
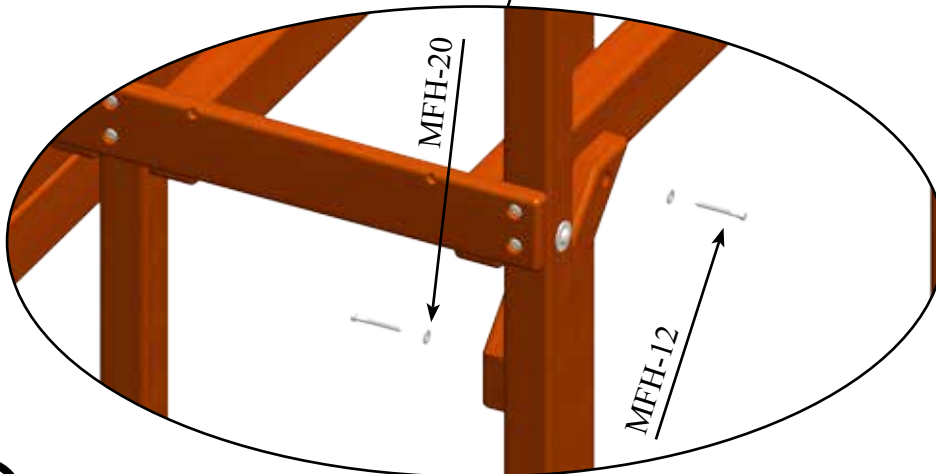
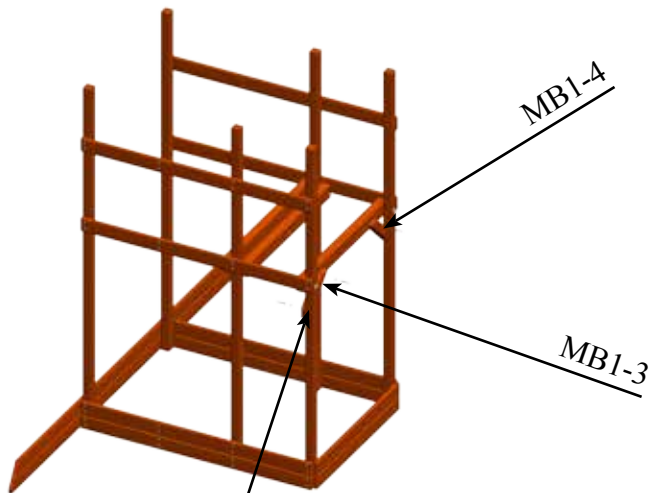



# MAIN ASSEMBLY

## PARTS NEEDED

MB1-3- (L) Gusset Bracket- (1)  
MB1-4- (R) Gusset Bracket- (1)

## HARDWARE NEEDED

MFH-12- 3/8" x 3 1/2" Hex Lag Screw- (4)  
MFH-20- 3/8" USS Flatwasher- (4)

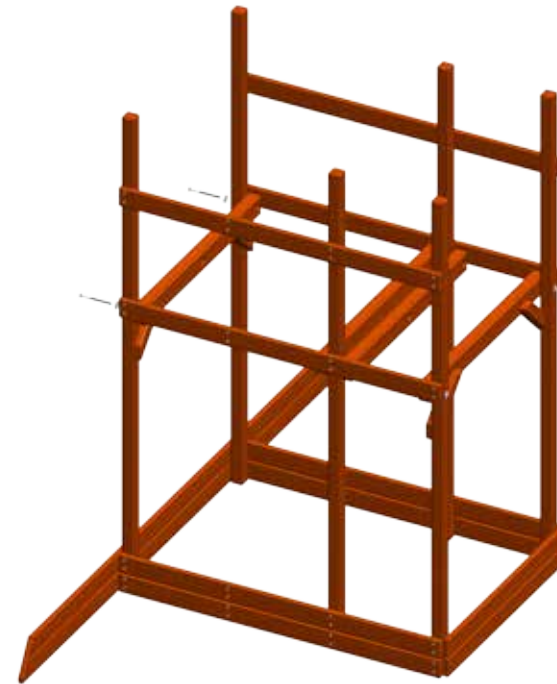
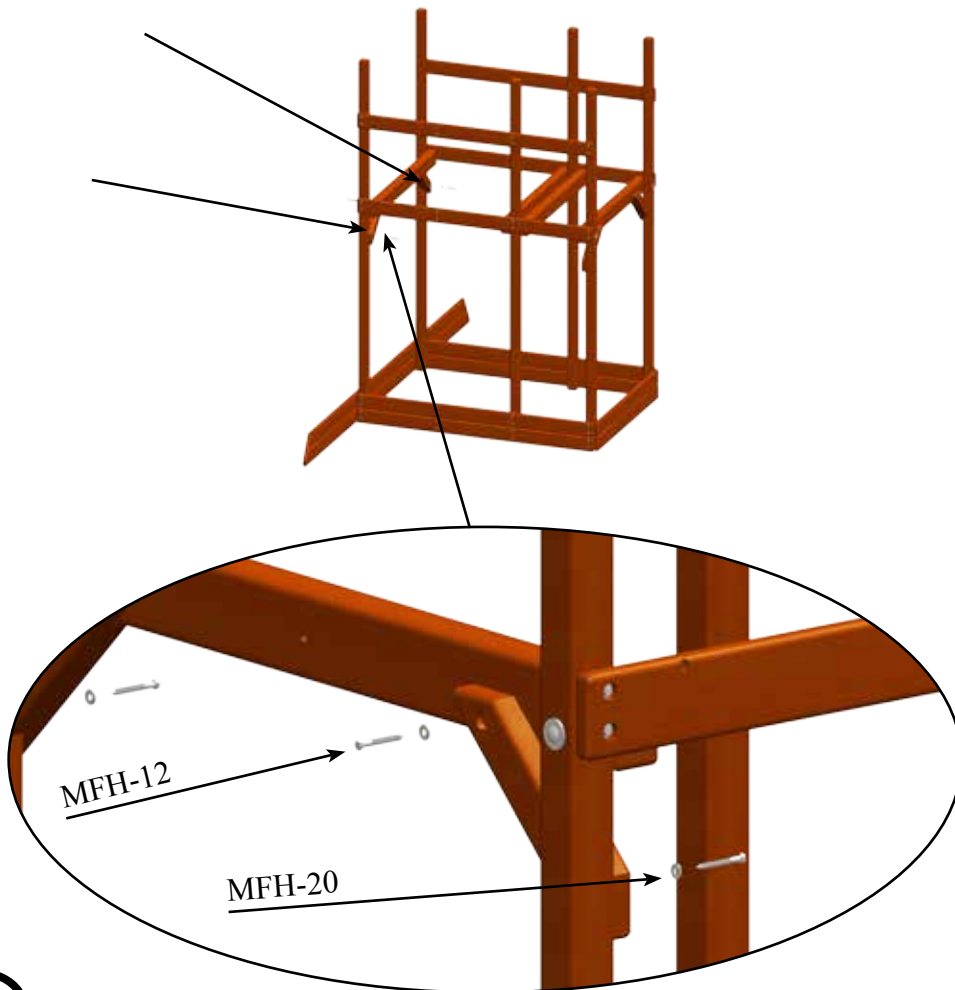

Take off the Carriage Bolt and Washer. Mainbeam will be held by Gussets temporarily.

# MAIN ASSEMBLY

## PARTS NEEDED

Universal Decks-

(2)

## HARDWARE NEEDED

MFH-11- 1/4" x 4 1/2" Hex Lag Screw-

(16)

MFH-19- 1/4" USS Flatwasher-

(16)

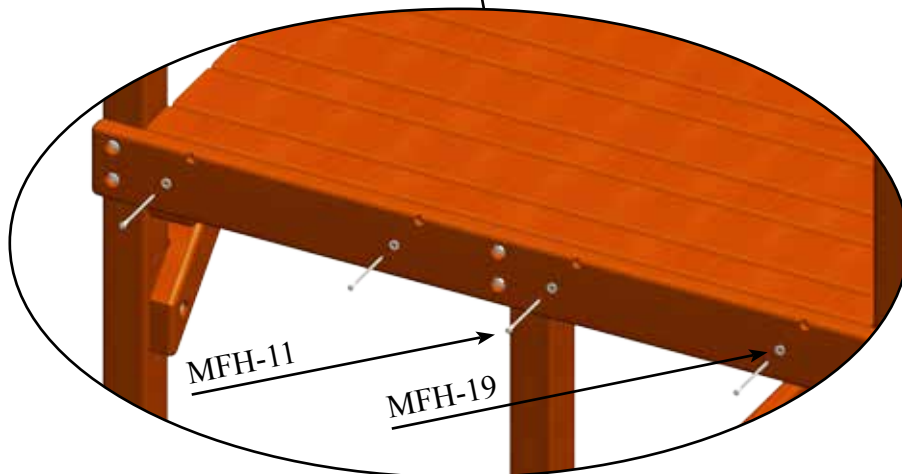
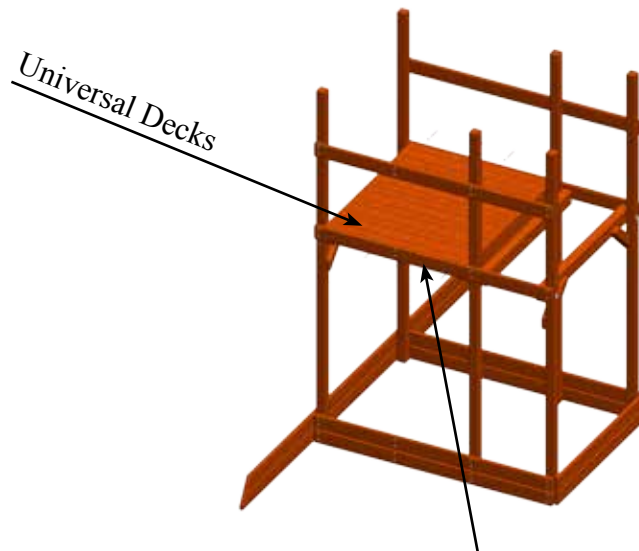

Bottom View

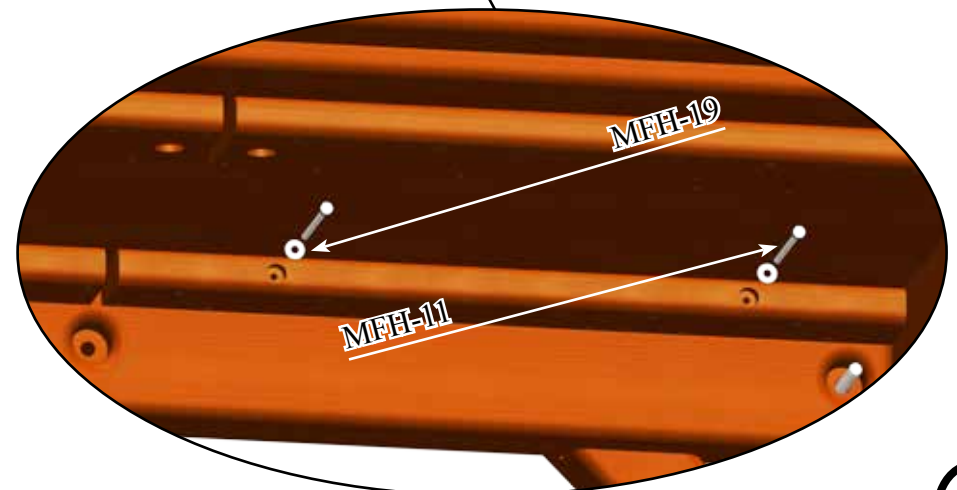
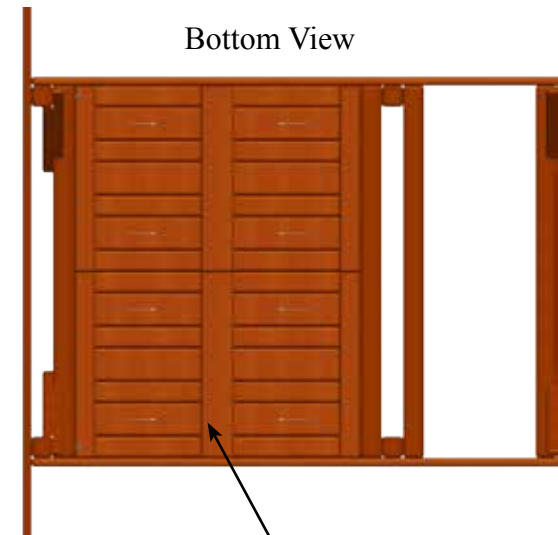



# MAIN ASSEMBLY

## PARTS NEEDED

MB2-6- Universal Rail Bottom- (2)  
MBA-4- 76" Fort Wing Mainbeam- (1)

MFH-10- 1/4" x 3" Hex Lag Screw- (4)  
MFH-2- 1/2" Acorn Nut- (2)  
MFH-17- 1/2" Split Lockwasher- (2)  
MFH-22- 3/4" USS Flatwasher- (2)

## HARDWARE NEEDED

MFH-19- 1/4" USS Flatwasher- (4)  
MFH-7- 1/2" Hex Nut- (2)  
MFH-21- 1/2" USS Flatwasher- (2)  
7MFH-11- 1/2" x 8 1/2" Carriage Bolt- (2)

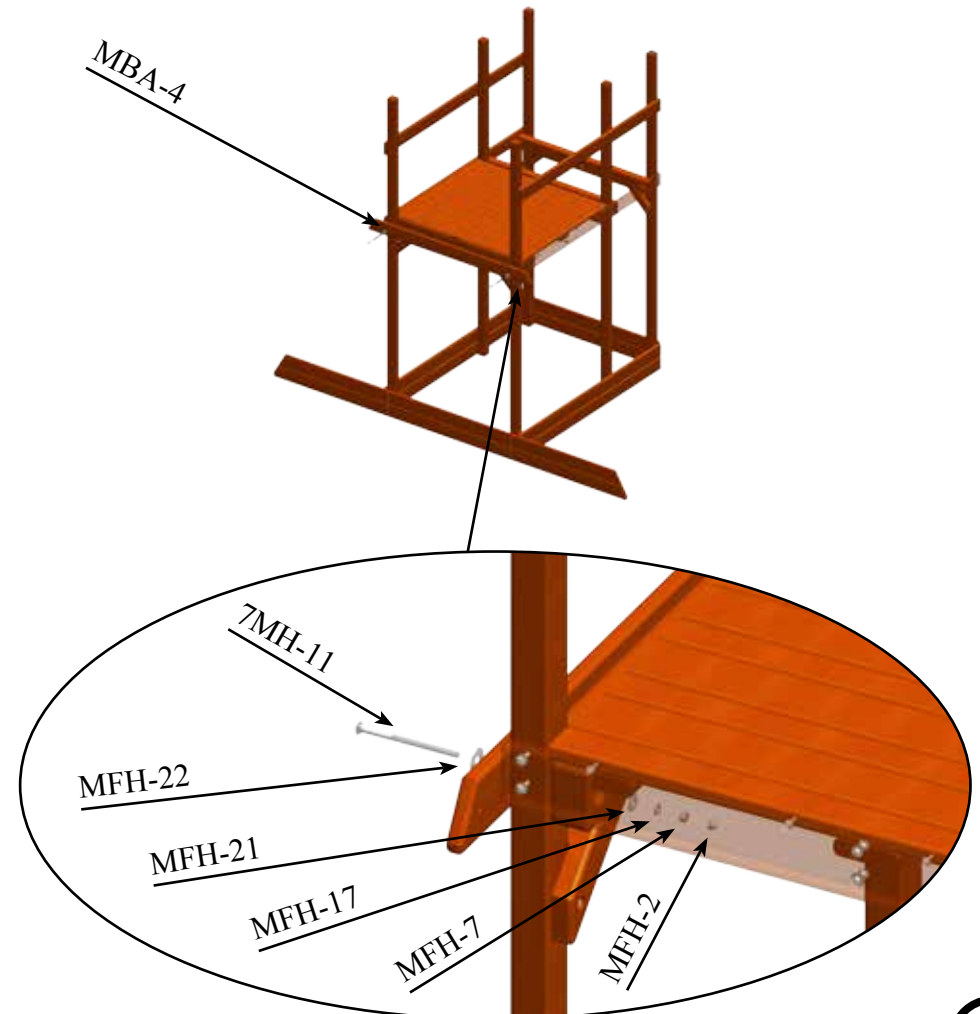
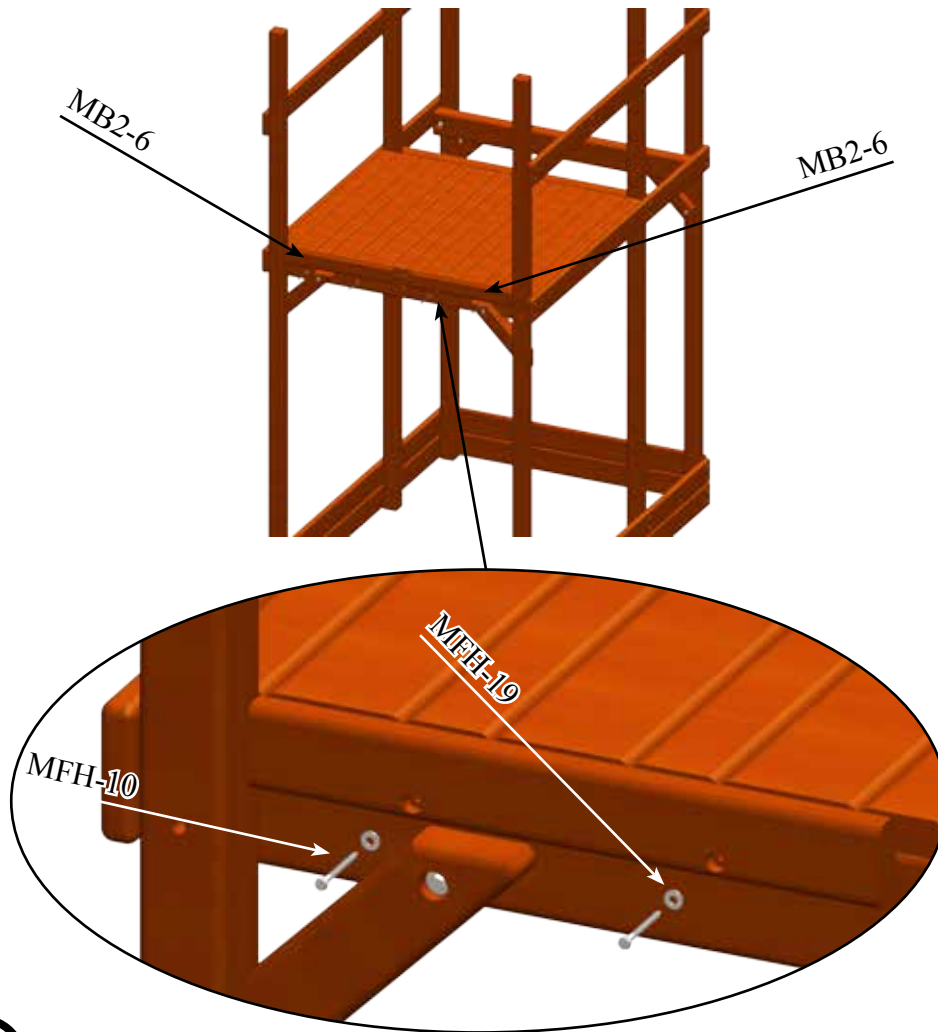

# MAIN ASSEMBLY

## PARTS NEEDED

(CTL+SHIFT+ Click to edit)

## HARDWARE NEEDED

(CTL+SHIFT+CLICK to edit)

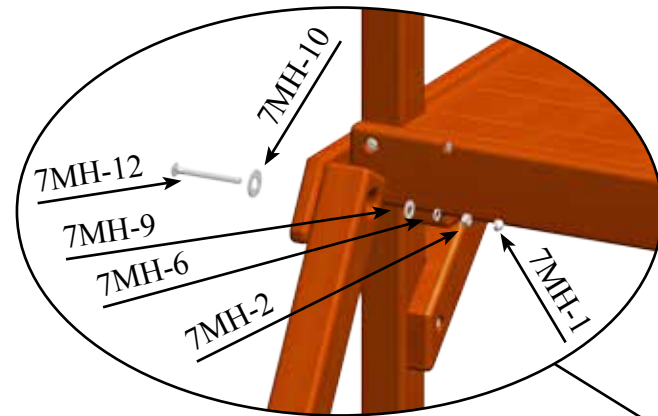

MBA-4

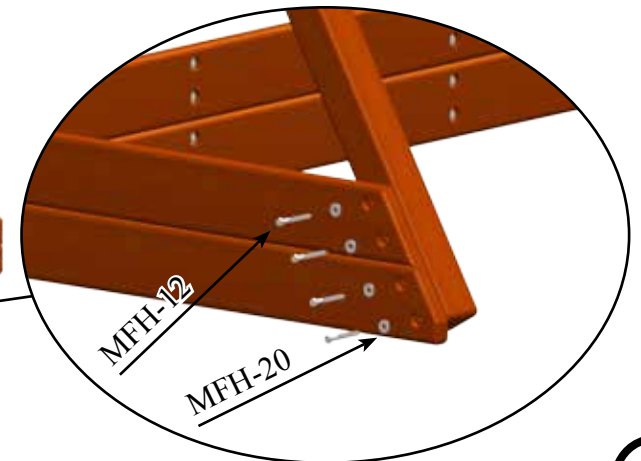

# MAIN ASSEMBLY

## PARTS NEEDED

MB2-4- Universal Filler- (3)  
Megadeck Decks- (2)

## HARDWARE NEEDED

MFH-11- 1/4" x 4 1/2" Hex Lag Screw- (6)  
MFH-19- 1/4" USS Flatwasher- (6)

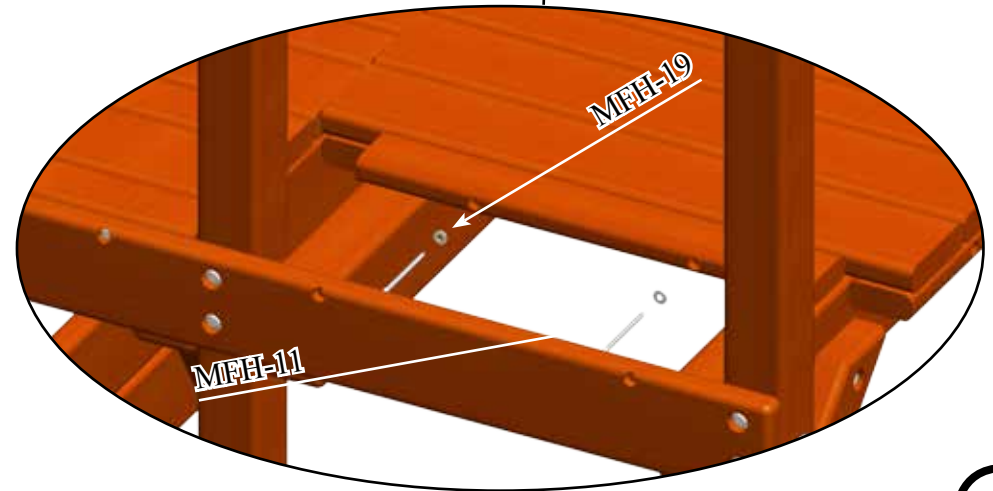
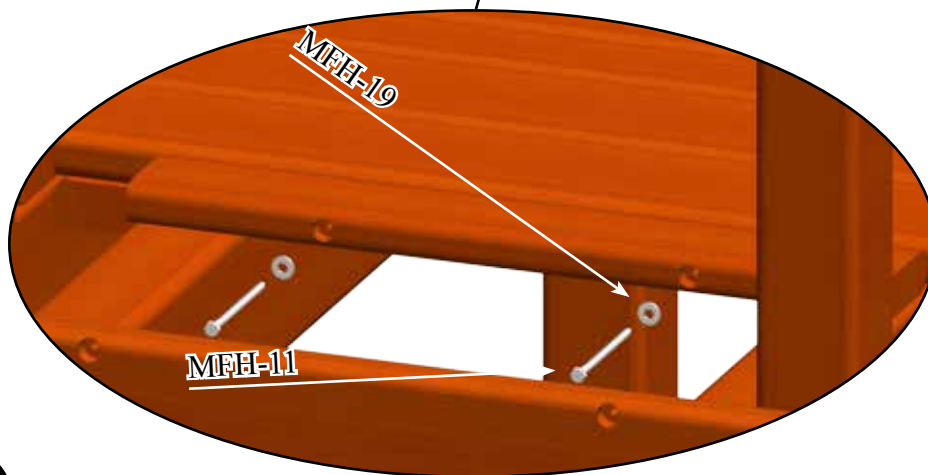
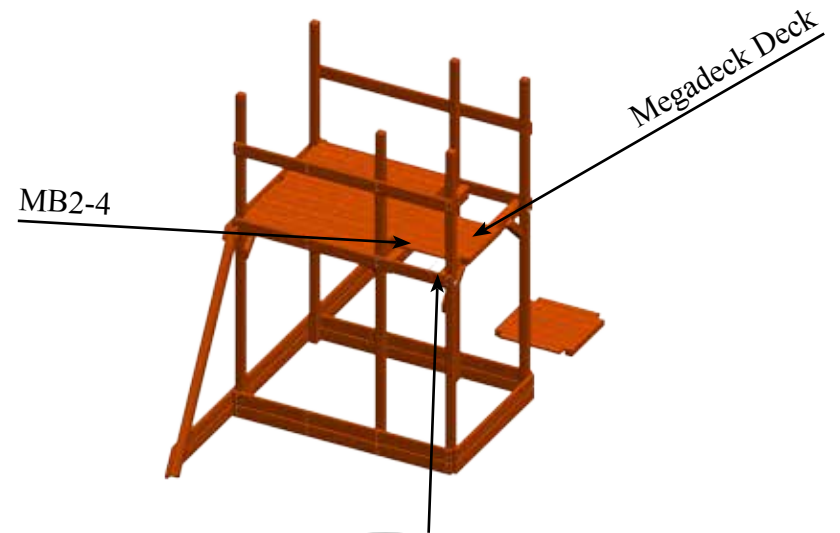
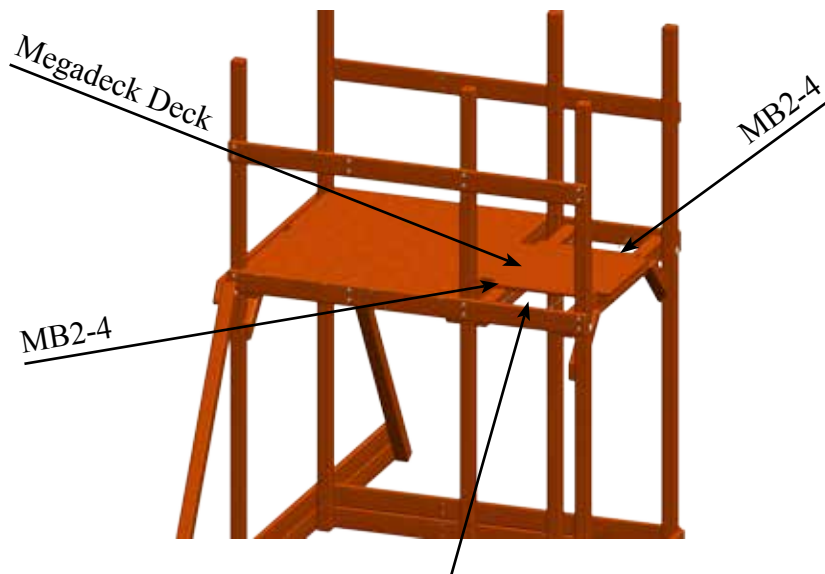

# MAIN ASSEMBLY

## PARTS NEEDED

MB1-5- Universal Fort Upright- (2)

## HARDWARE NEEDED

MFH-3- 1/2" x 7" Carriage Bolt- (1)  
MFH-21- 1/2" USS Flatwasher- (3)  
MFH-17- 1/2" Split Lockwasher- (2)  
MFH-2- 1/2" Acorn Nut- (2)

MFH-24- 1/2" x 9" Hex Bolt- (1)  
MFH-22- 3/4" USS Flatwasher- (1)  
MFH-7- 1/2" Hex Nut- (2)

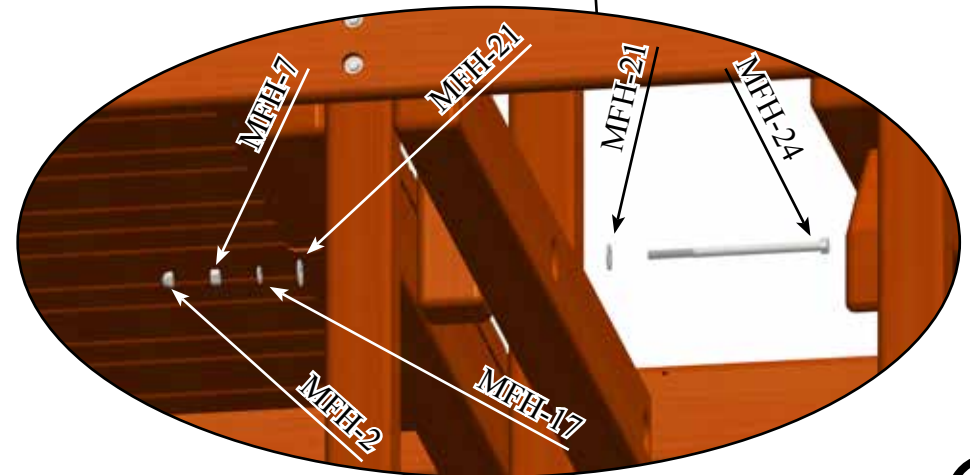
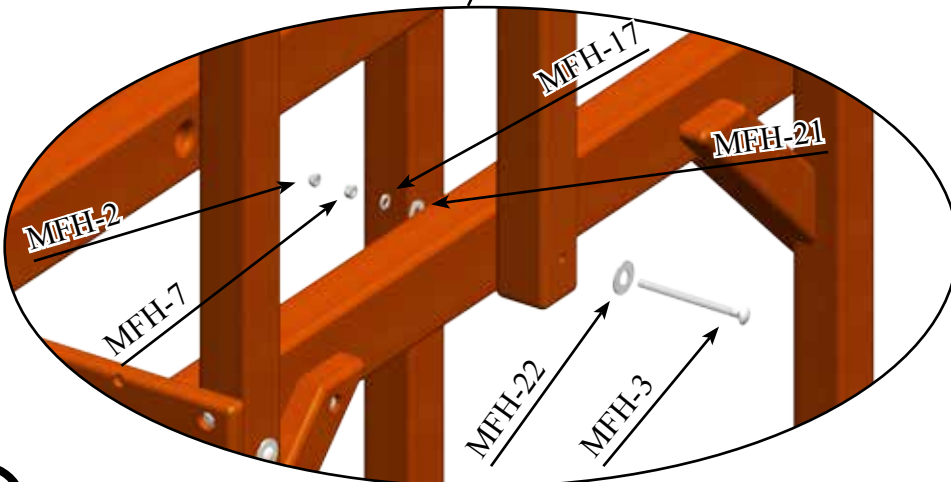
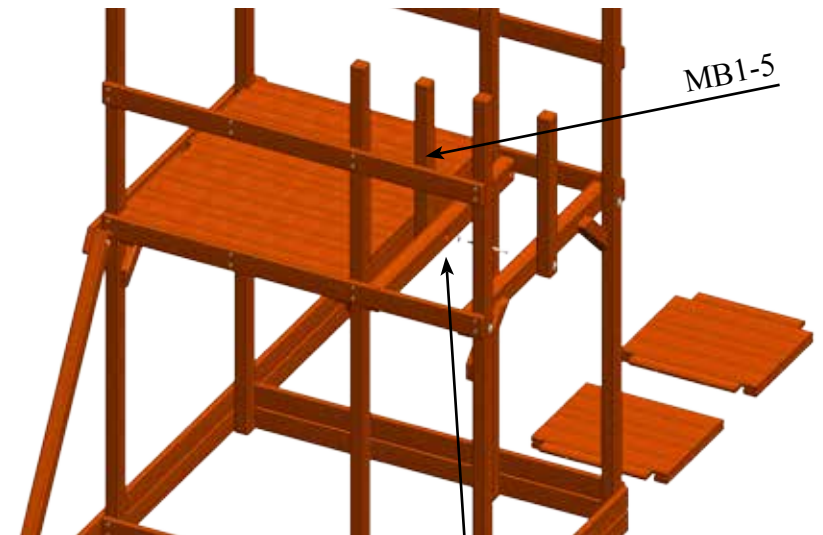
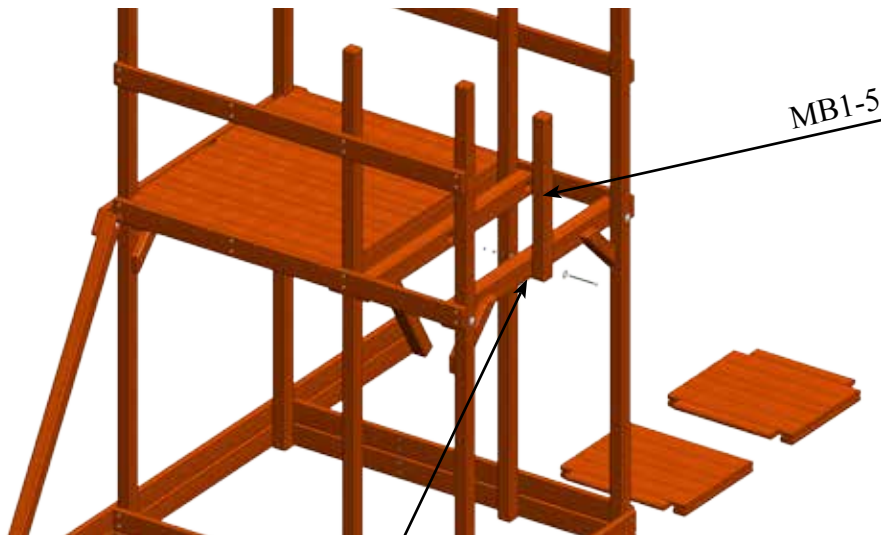



# MAIN ASSEMBLY

## PARTS NEEDED

Megadeck Decks- (2)  
MB1-5- Fort Center Upright- (1)

7MH-11- 1/2" x 8 1/2" Carriage Bolt- (1)  
MFH-21- 1/2" USS Flatwasher- (1)  
MFH-7-1/2" Hex Nut- (1)  
MFH-11- 1/4" x 4 1/2" Hex Lag Screw- (8)

## HARDWARE NEEDED

MFH-22- 3/4" USS Flatwasher- (1)  
MFH-17- 1/2" Split Lockwasher- (1)  
MFH-2- 1/2" Hex Nut- (1)  
MFH-19- 1/4" USS Flatwasher- (8)

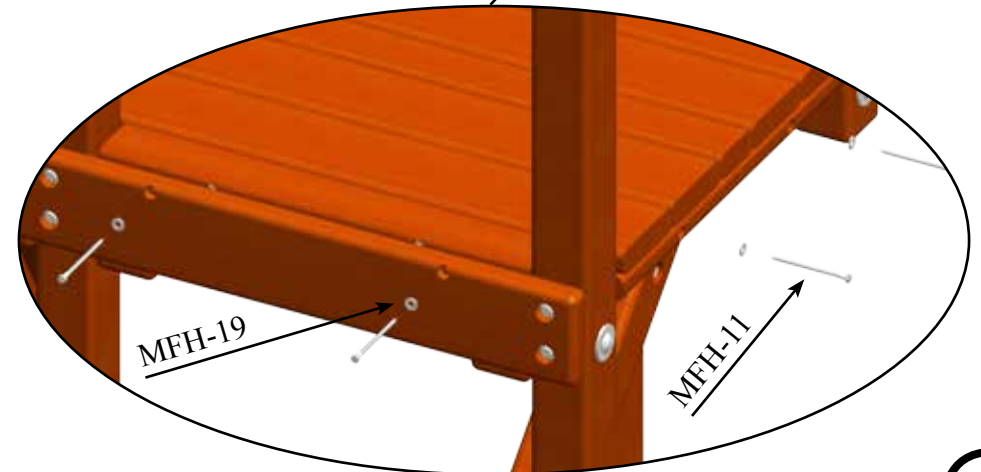
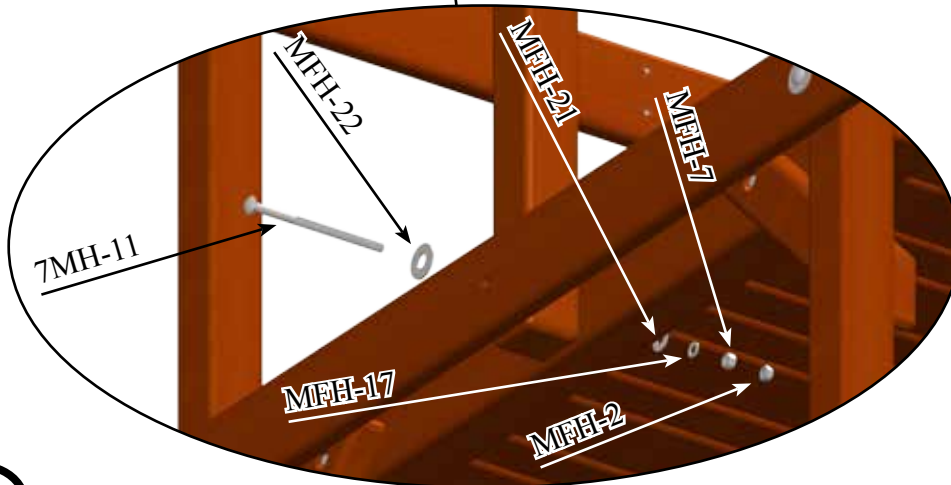
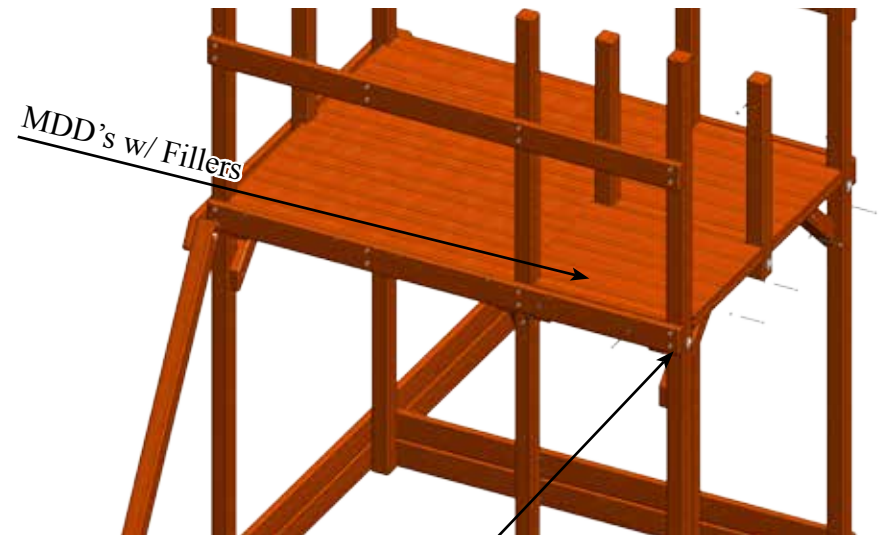
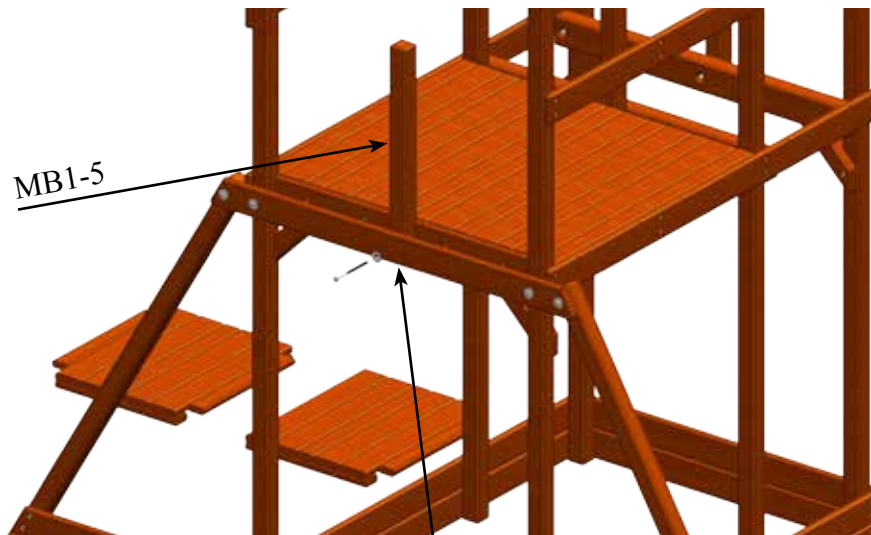

# MAIN ASSEMBLY

## PARTS NEEDED

Ladder Assembly- (1)  
MB1-6- Universal Fort WR Center Post- (2)

## HARDWARE NEEDED

7MH-8- 3/8"USS Flatwasher-	(2)	7MH-5- 3/8" x 5" Hex Lag Screw-	(2)
7MH-4- 3/8" x 3 1/2" Hex Lag Screw-	(2)	MST-6- Ladder Bracket-	(1)
MFH-12- 3/8" x 3 1/2" Hex Lag Screw-	(4)	MFH-20- 3/8" USS Flatwasher-	(6)
RWH-4- 3/8" x 5" Hex Lag Screw-	(2)		

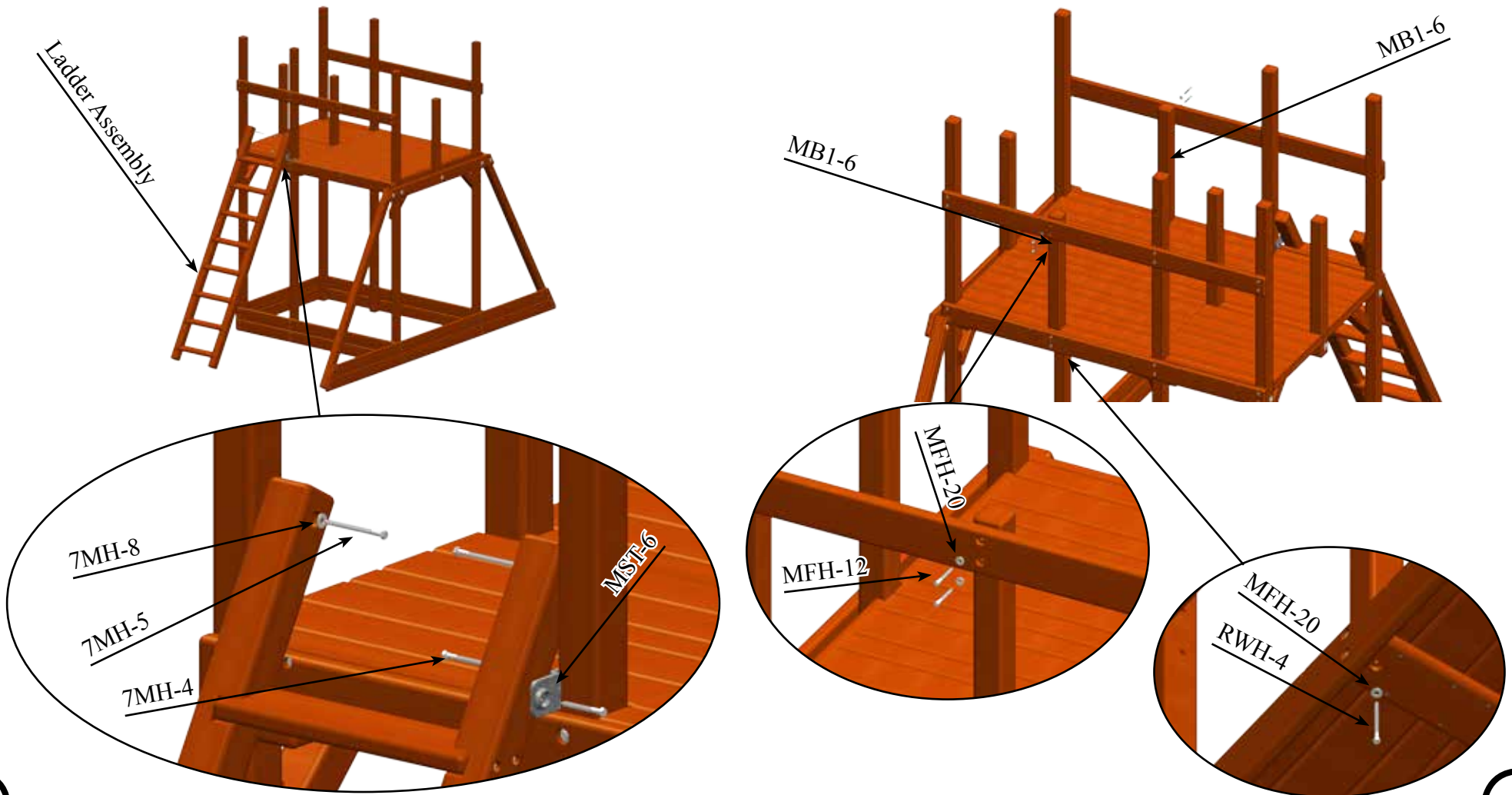

# MAIN ASSEMBLY

## PARTS NEEDED

MB2-5- Fort Playhouse Panel Facia- (1)  
 MB1-2- Universal Fort Top Joist SB- (1)  
 MB1-7- Universal Fort Trapeze Arm- (1)

## HARDWARE NEEDED

MFH-3- 1/2" x 7" Carriage Bolt- (6)  
 MFH-21- 1/2" USS Flatwasher- (6)  
 MFH-7- 1/2" Hex Nut- (6)  
 MFH-12- 3/8" x 3 1/2" Hex Lag Screw- (4)  
 MFH-22- 3/4" USS Flatwasher- (6)  
 MFH-17- 1/2" Split Lockwasher- (6)  
 MFH-2- 1/2" Acorn Nut- (6)  
 MFH-20- 3/8" USS Flatwasher- (4)

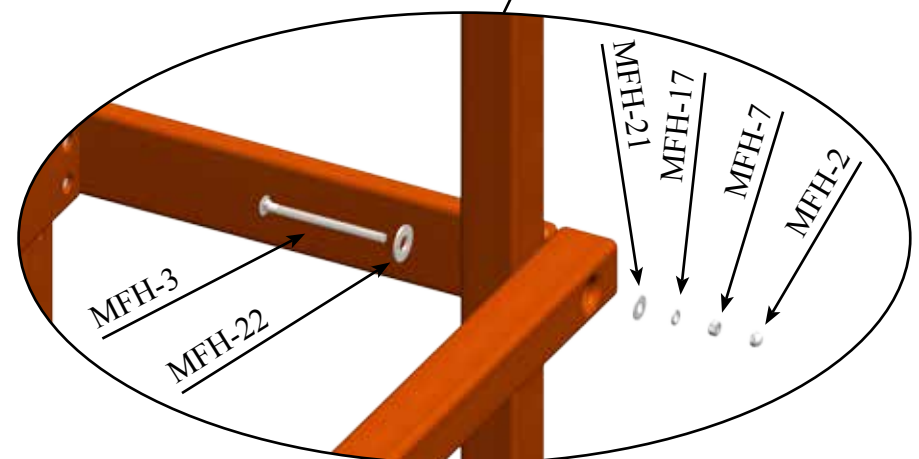
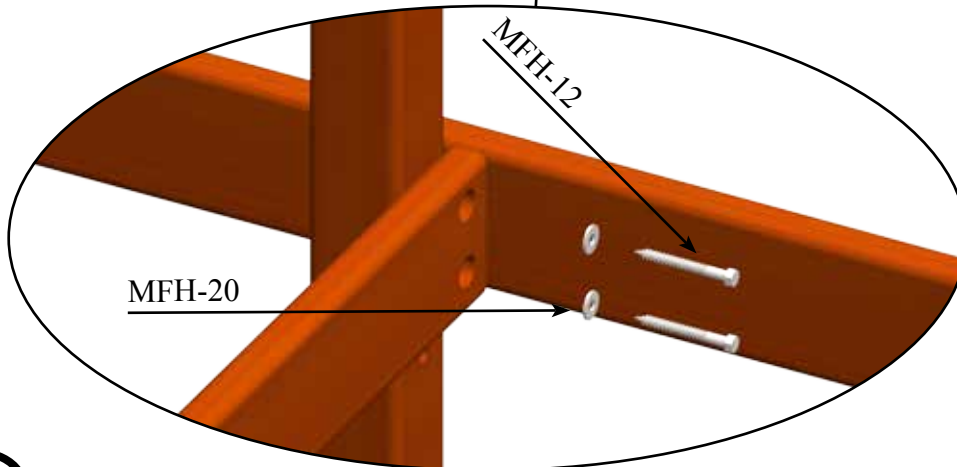
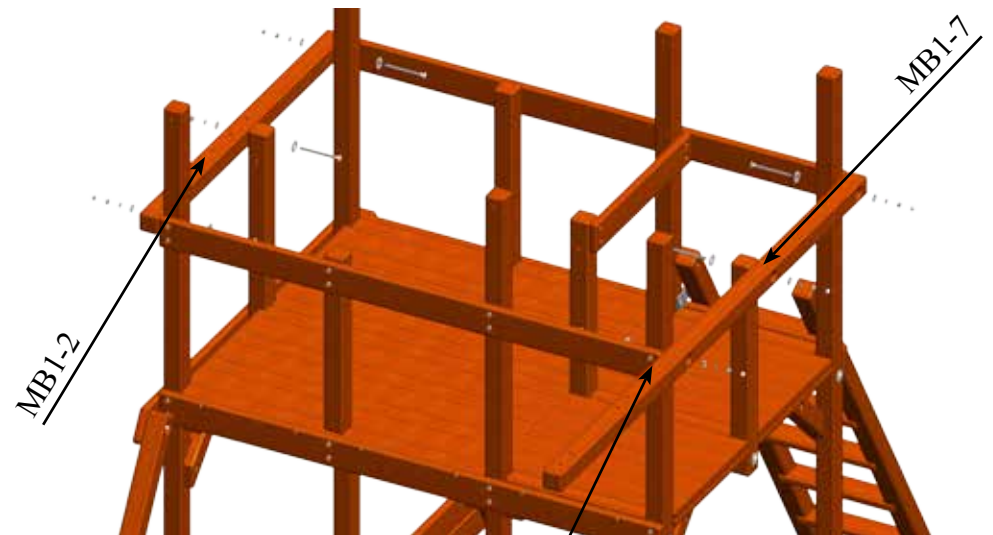
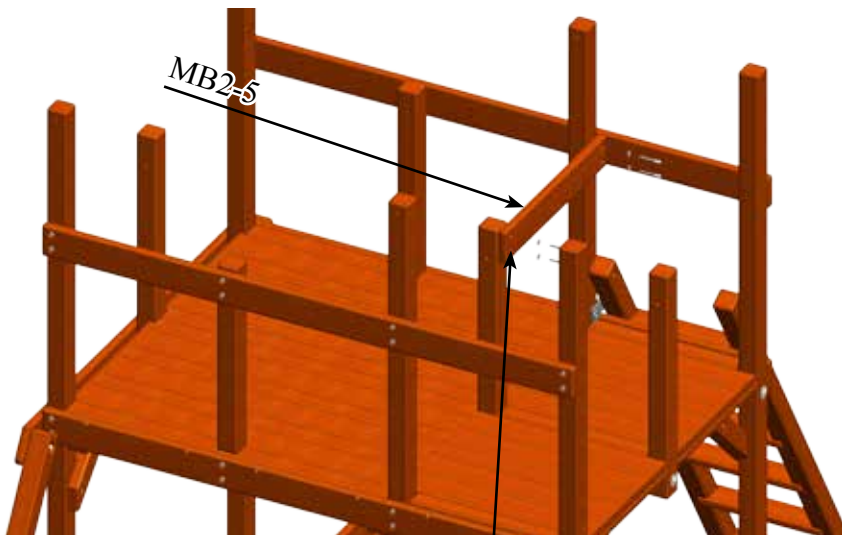



# MAIN ASSEMBLY

## PARTS NEEDED

Rockwall Assembly- (1)  
Rail Assemblies- (Depends on Package)

## HARDWARE NEEDED

RWH-4- 3/8" x 5" Hex Lag Screw- (2)  
RWH-5- 3/8" USS Flatwasher- (2)  
MFH-11- 1/4" x 4 1/2" Hex Lag Screw- (2 Per Rail)  
MFH-9- 1/4" x 2" Hex Lag Screw- (2 Per Rail)  
MFH-19- 1/4" USS Flatwasher- (4 Per Rail)

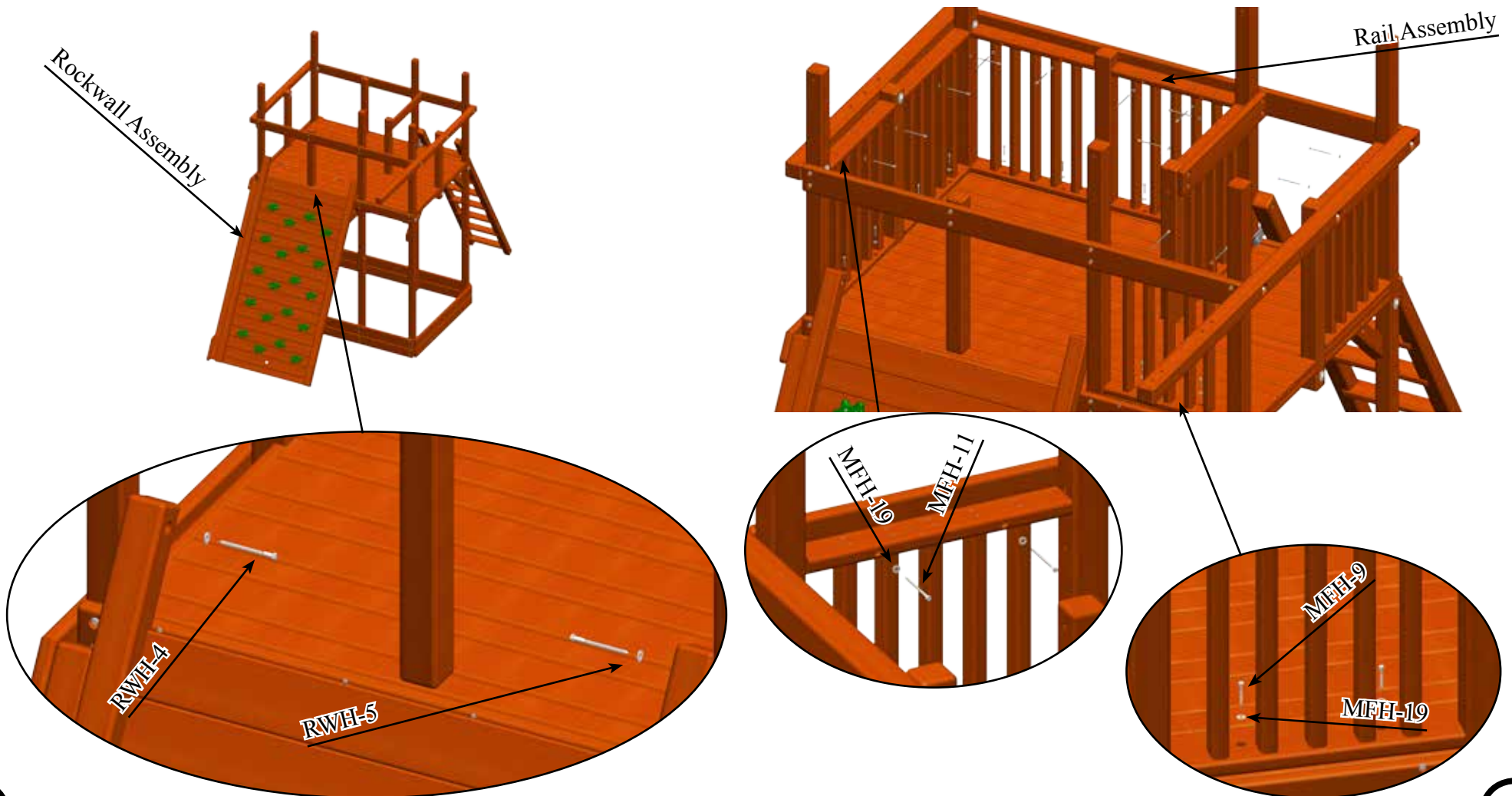



# MAIN ASSEMBLY

## PARTS NEEDED

RW-7- Universal Rope Block- (1)

MFH-8- 3/8" x 5" Hex Bolt- (4)

MFH-20- 3/8" USS Flatwasher- (4)

MFH-6- 3/8" Hex Nut- (4)

RWH-5- 3/8" USS Flatwasher- (2)

## HARDWARE NEEDED

MFH-26- 3/8" Bolt Cup- (4)

MFH-16- 3/8" Split Lockwasher- (4)

MFH-1- 3/8" Acorn Nut- (4)

RWH-4- 3/8" x 5" Hex Lag Screw- (2)

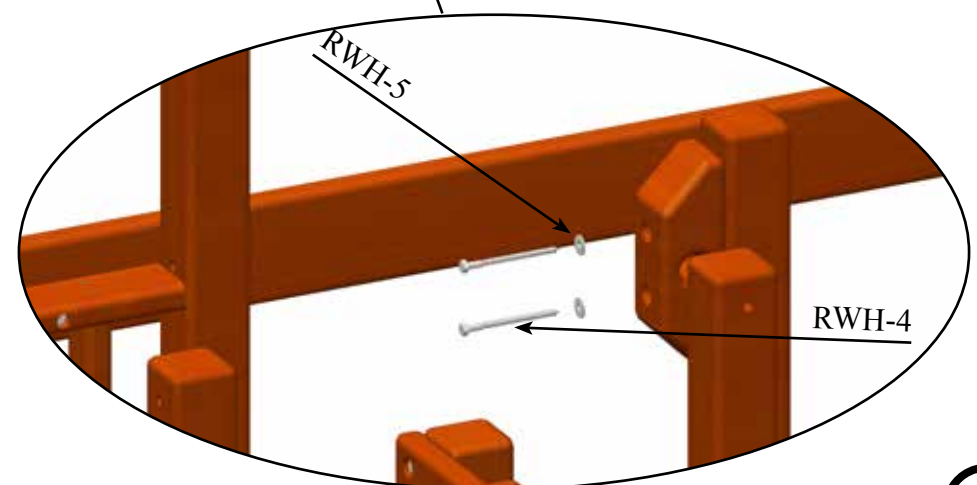
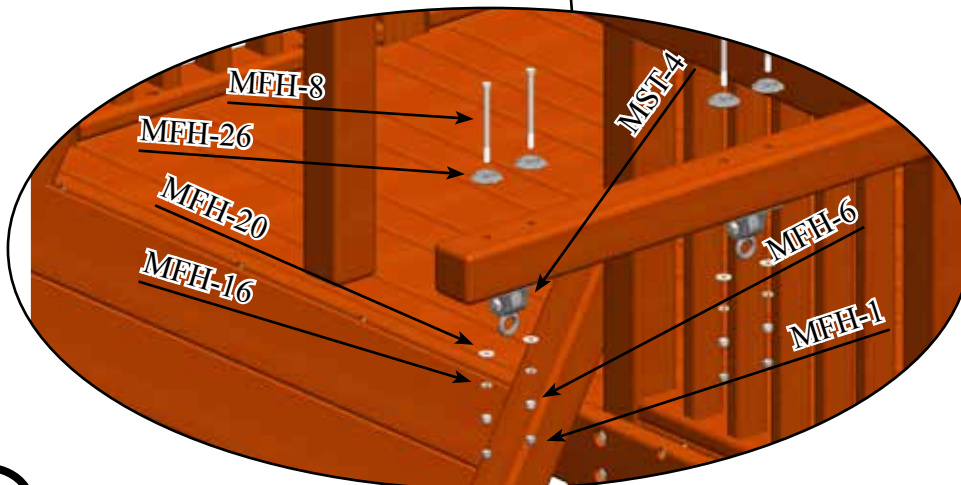

# MAIN ASSEMBLY

## PARTS NEEDED

WR-1- Universal Wood Roof Support- (4)  
WR-3- Fort Wood Roof Panel- (1)

## HARDWARE NEEDED

MFH-25- 3/8" x 5 1/2" Carriage Bolt- (4)	MFH-21- 1/2" USS Flatwasher- (4)
MFH-20- 3/8" USS Flatwasher- (4)	MFH-16- 3/8" Split Lockwasher- (4)
MFH-6- 3/8" Hex Nut- (4)	MFH-1- 3/8" Acorn Nut- (4)
MFH-11- 1/4" x 4 1/2" Hex Lag Screw- (4)	MFH-19- 1/4" USS Flatwasher- (4)

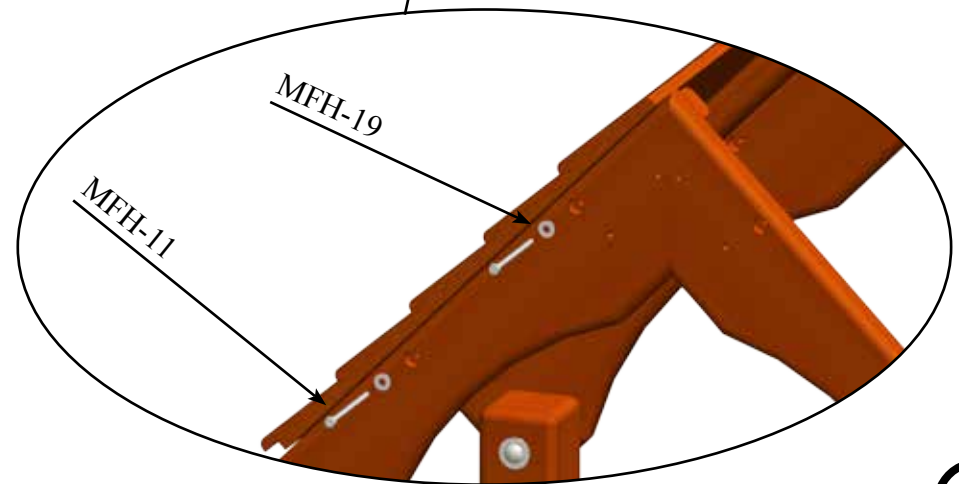
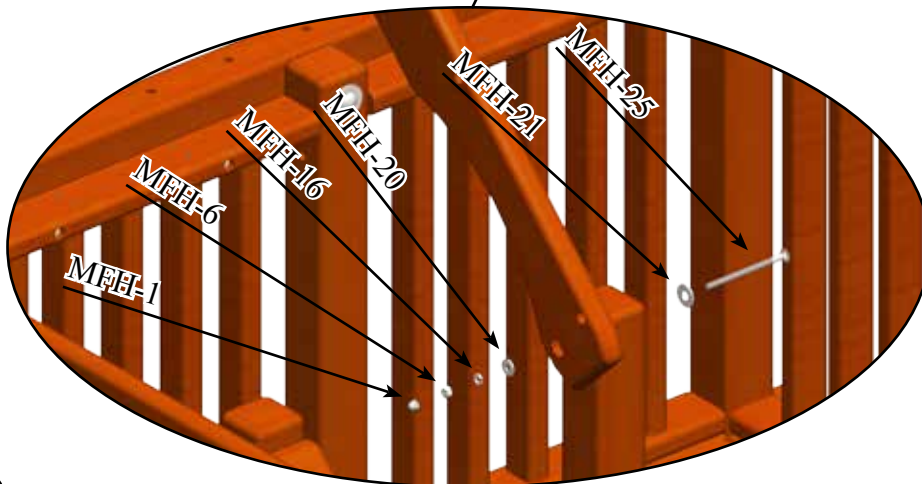
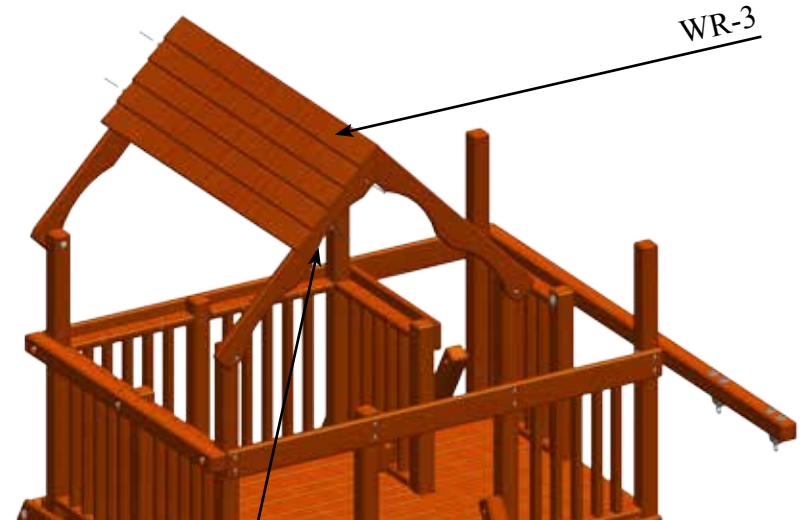
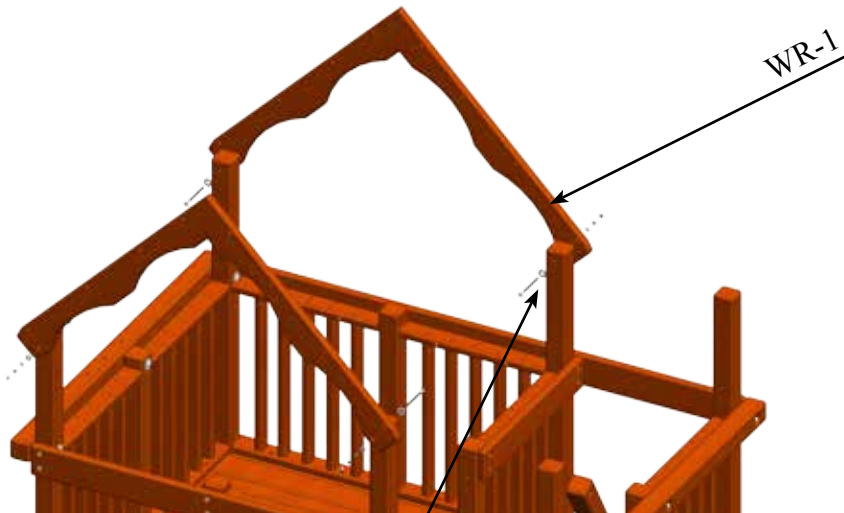

# MAIN ASSEMBLY

## PARTS NEEDED

WR-3- Fort Wood Roof Panel- (1)  
WR-4- Universal Wood Roof Peak Facia- (2)

## HARDWARE NEEDED

MFH-11- 1/4" x 4 1/2" Hex Lag Screw- (4)  
MFH-19- 1/4" USS Flatwasher- (4)  
MFH-5- 2 1/2" Coated Deck Screw- (8)

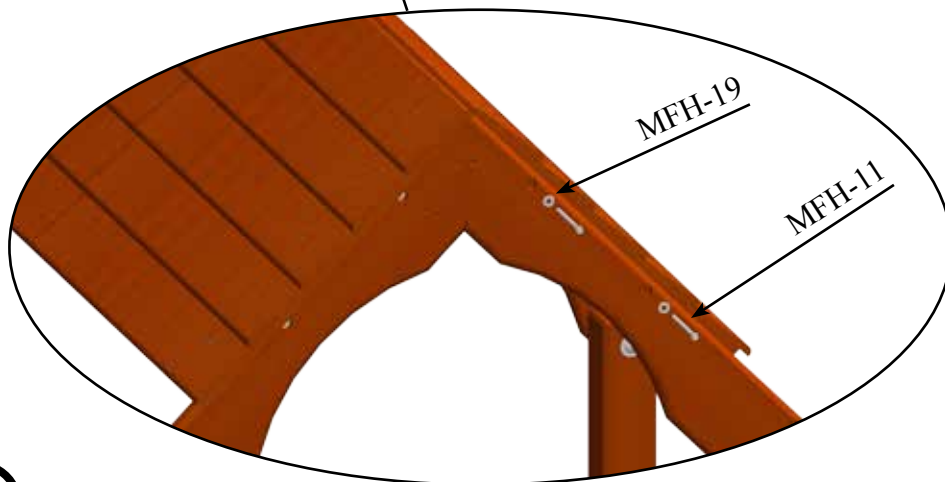

Back View

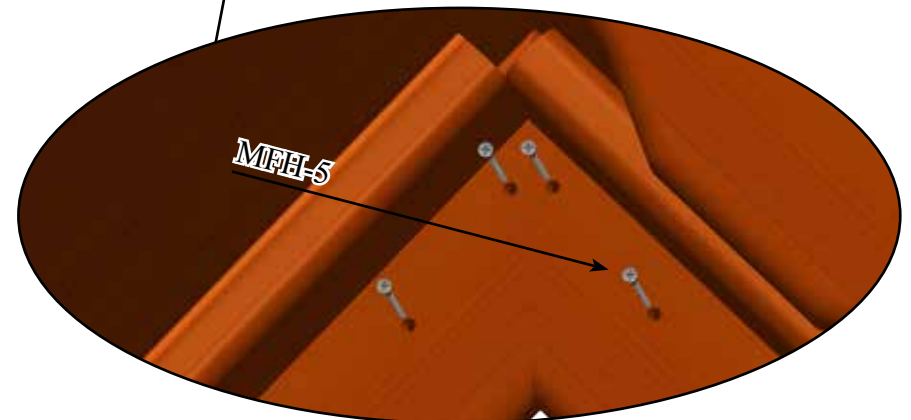



# MAIN ASSEMBLY

## PARTS NEEDED

WR-3- Fort Wood Roof Panel- (1)  
WR-10- Megadeck (L) Angled WR Panel- (1)

## HARDWARE NEEDED

MFH-11- 1/4" x 4 1/2" Hex Lag Screw- (6)  
MFH-19- 1/4" USS Flatwasher- (6)

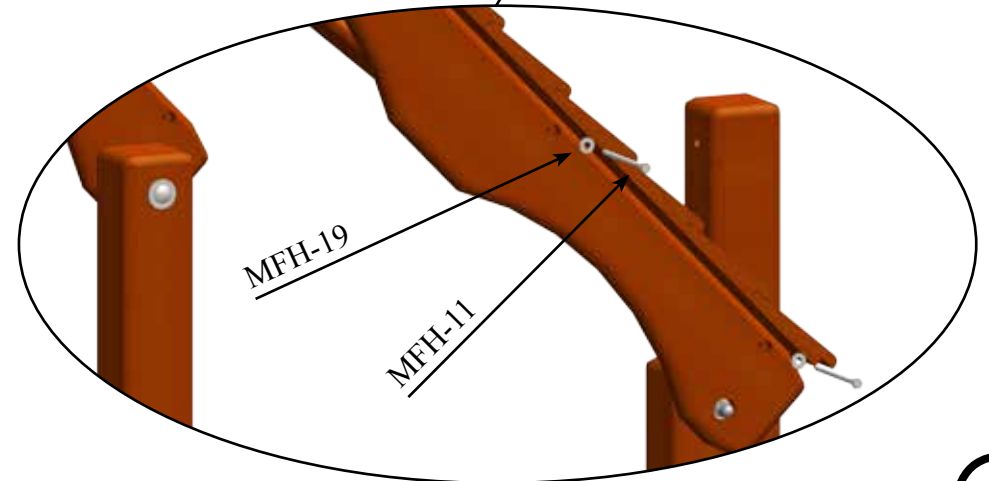
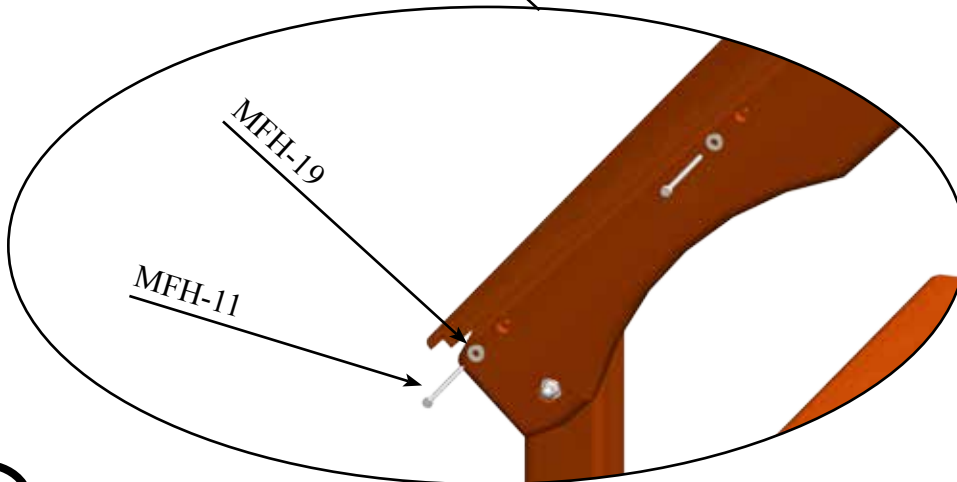

# MAIN ASSEMBLY

## PARTS NEEDED

WR-9- Megadeck (L) WR Panel- (1)  
WR-1- Universal Fort WR Support- (2)

## HARDWARE NEEDED

MFH-11- 1/4" x 4 1/2" Hex Lag Screw- (2)	MFH-19- 1/4" USS Flatwasher- (2)
MFH-25- 3/8" x 5 1/2" Carriage Bolt- (2)	MFH-21- 1/2" USS Flatwasher- (2)
MFH-20- 3/8" USS Flatwasher- (2)	MFH-16- 3/8" Split Lockwasher- (2)
MFH-6- 3/8" Hex Nut- (2)	MFH-1- 3/8" Acorn Nut- (2)

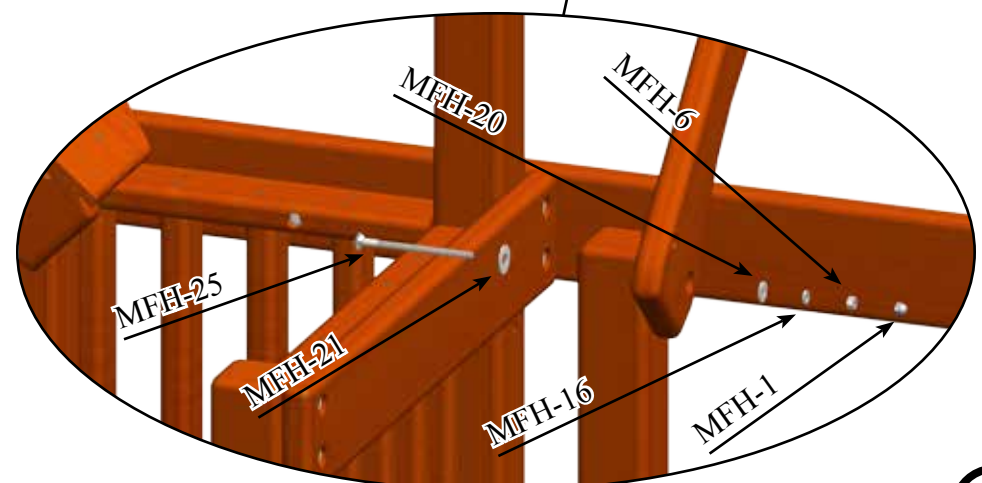
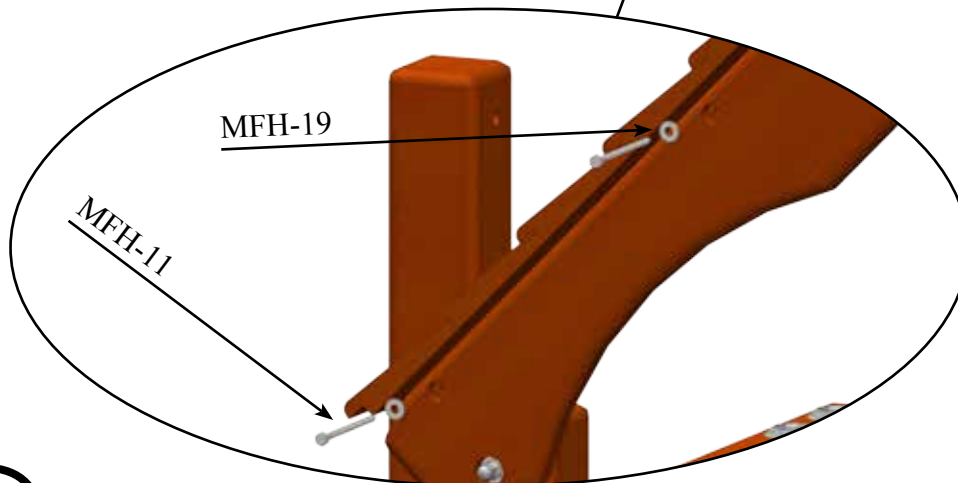

# MAIN ASSEMBLY

## PARTS NEEDED

WR-5- Megadeck (L) Top Dormer Panel- (1)  
WR-6- Megadeck (R) Top Dormer Panel- (1)

## HARDWARE NEEDED

MFH-11- 1/4" x 4 1/2" Hex Lag Screw- (4)  
MFH-19- 1/4" USS Flatwasher- (4)

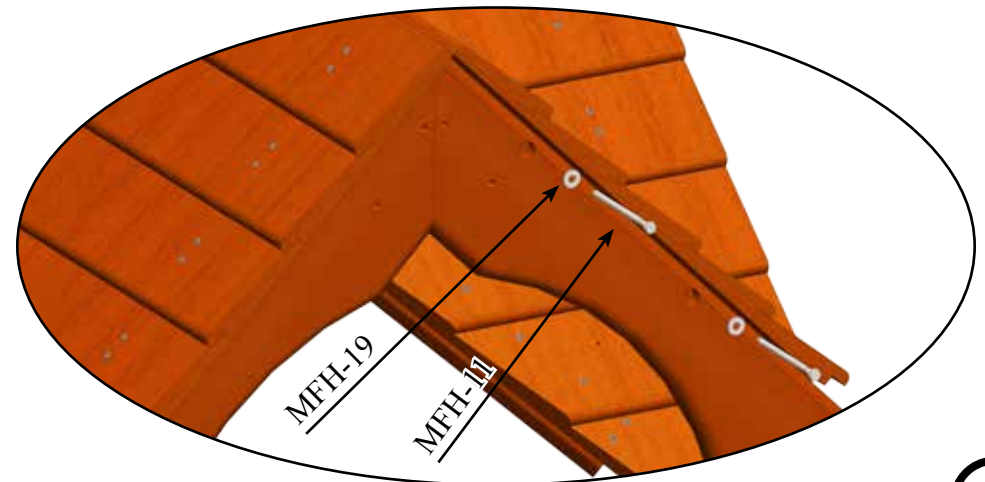
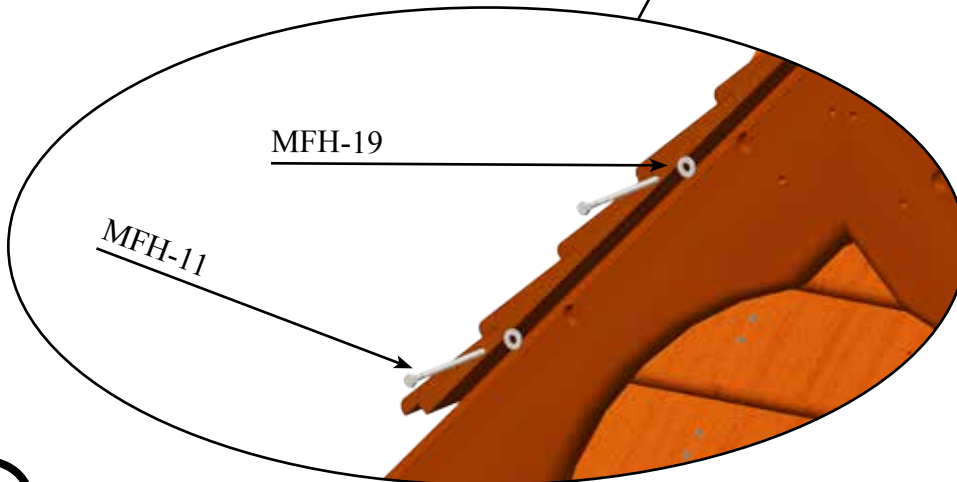
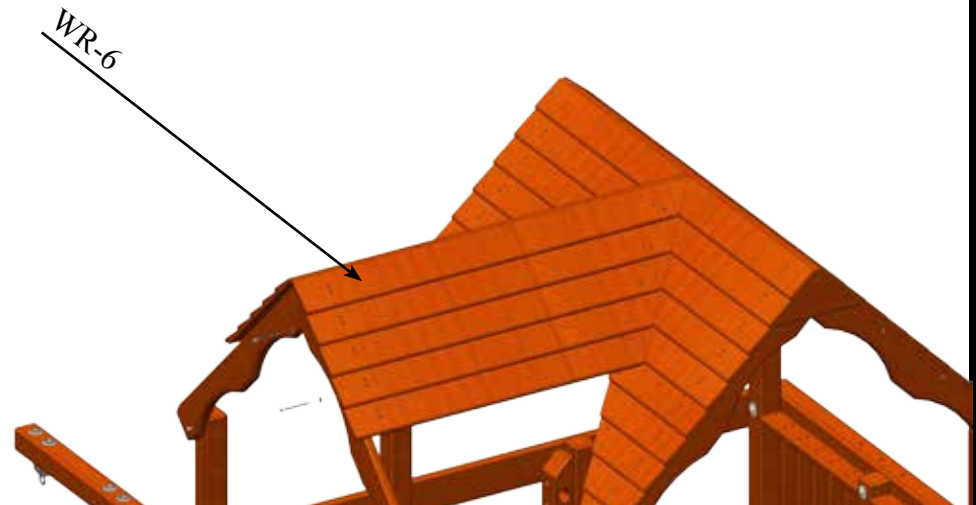
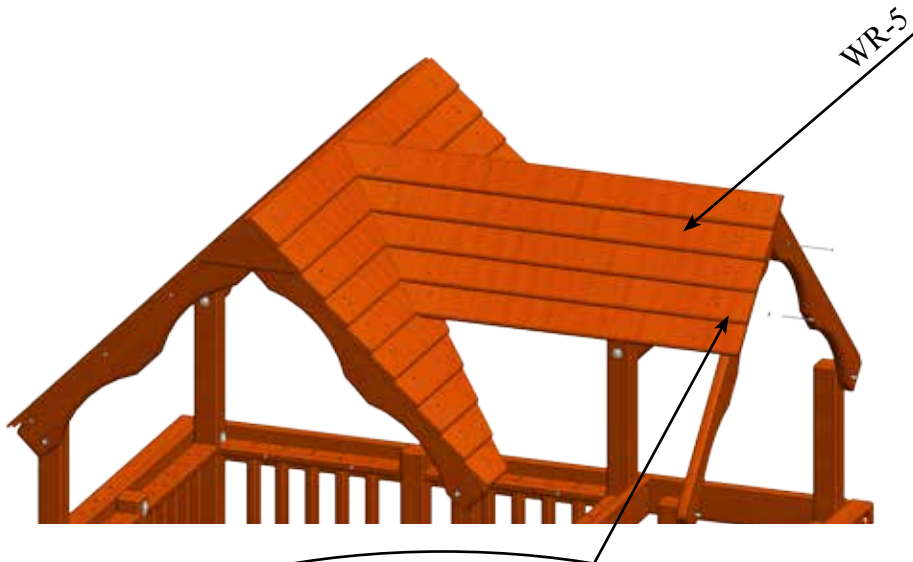



# MAIN ASSEMBLY

## PARTS NEEDED

WR-4- Universal Wood Roof Peak Facia- (1)  
WR-7- Megadeck (L) Bottom Dormer WR Panel- (1)

## HARDWARE NEEDED

MFH-5- 2 1/2" Coated Deck Screw- (4)  
MFH-11- 1/4" x 4 1/2" Hex Lag Screw- (2)  
MFH-19- 1/4" USS Flatwasher- (2)



BACK VIEW

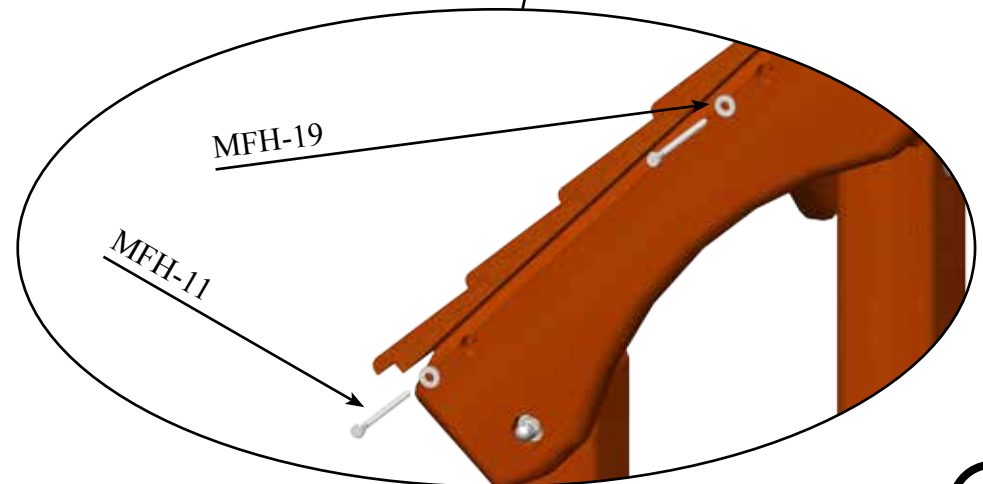
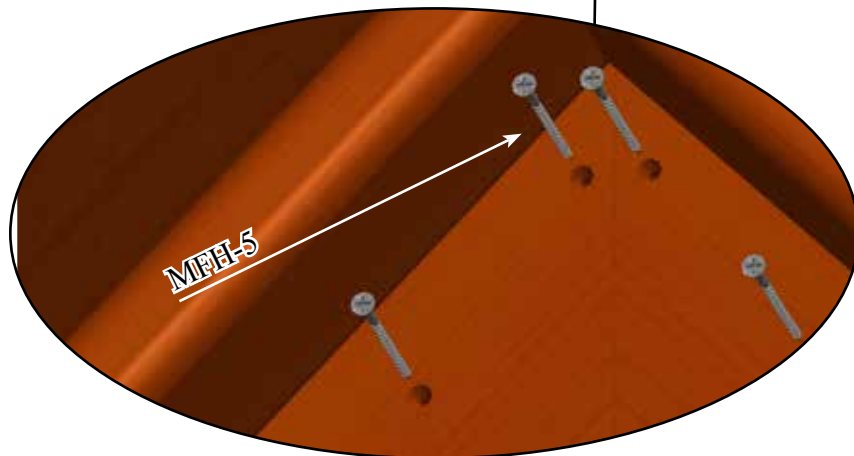

# MAIN ASSEMBLY

## PARTS NEEDED

WR-8- Megadeck (R) Bottom Dormer WR Panel- (1)

## HARDWARE NEEDED

MFH-19- 1/4" USS Flatwashers- (2)  
MFH-11- 1/4" x 4 1/2" Hex Lag Screw- (2)  
MFH-5- 2 1/2" Coated Deck Screw- (10)

WOOD SCREWS GO THROUGH THE WOOD ROOF BOARDS INTO THE SUPPORTS OF THE OVERLAPPING PANELS

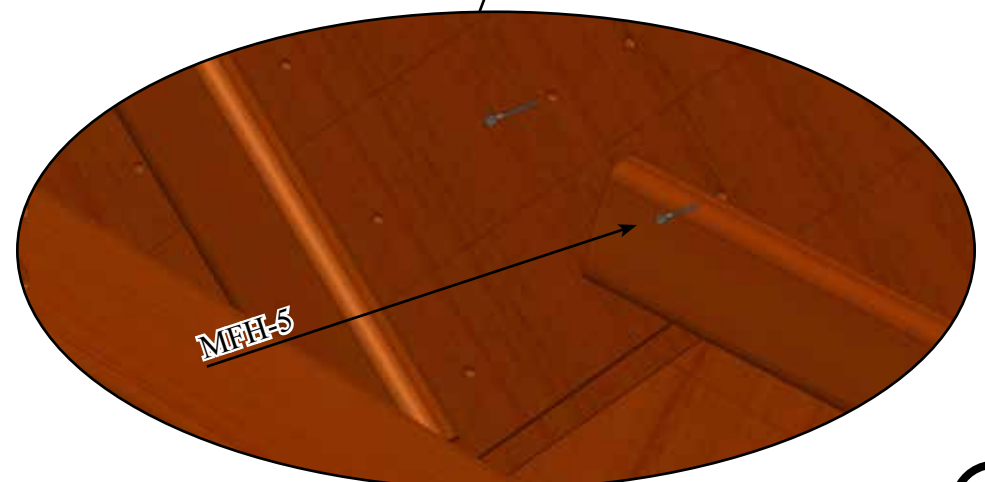
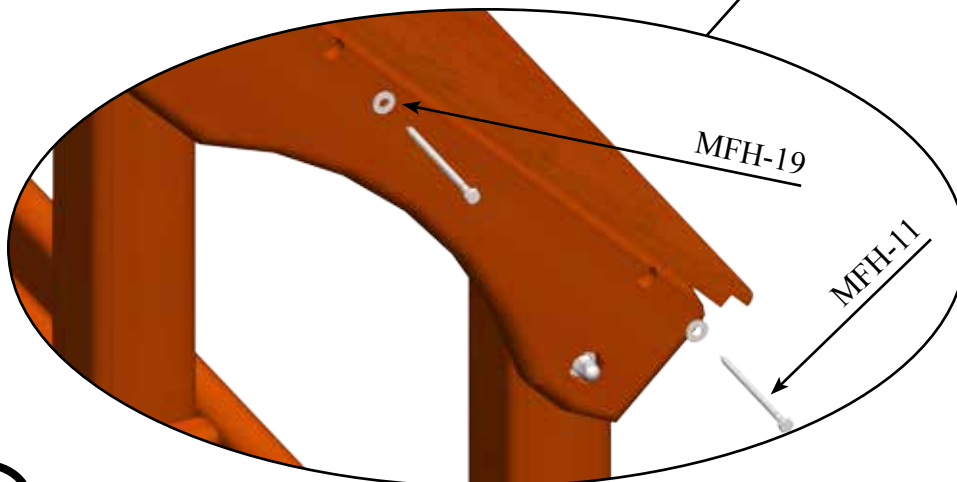
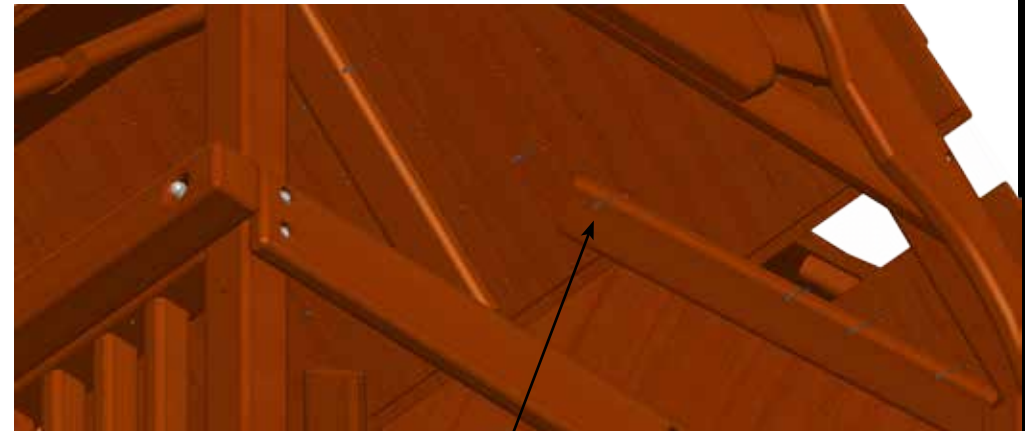



# MAIN ASSEMBLY

## PARTS NEEDED

(CTL+SHIFT+ Click to edit)

## HARDWARE NEEDED

(CTL+SHIFT+CLICK to edit)

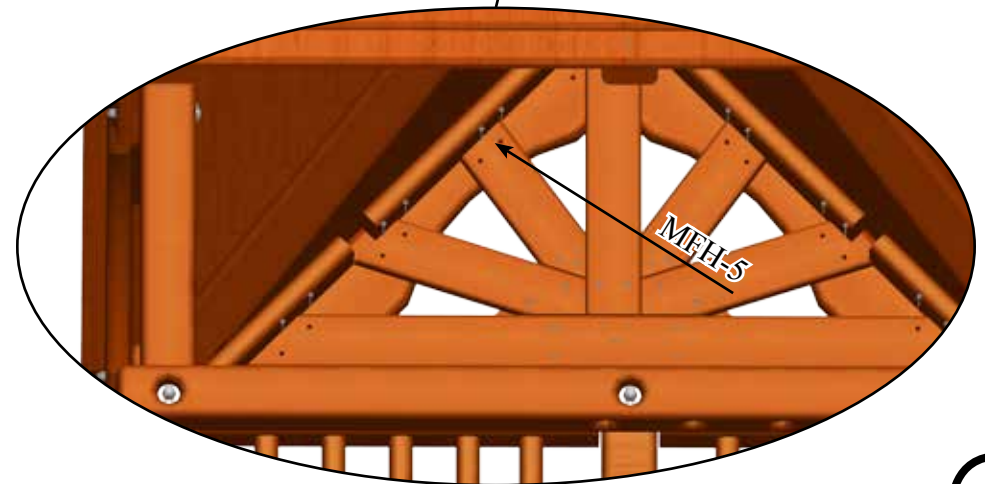
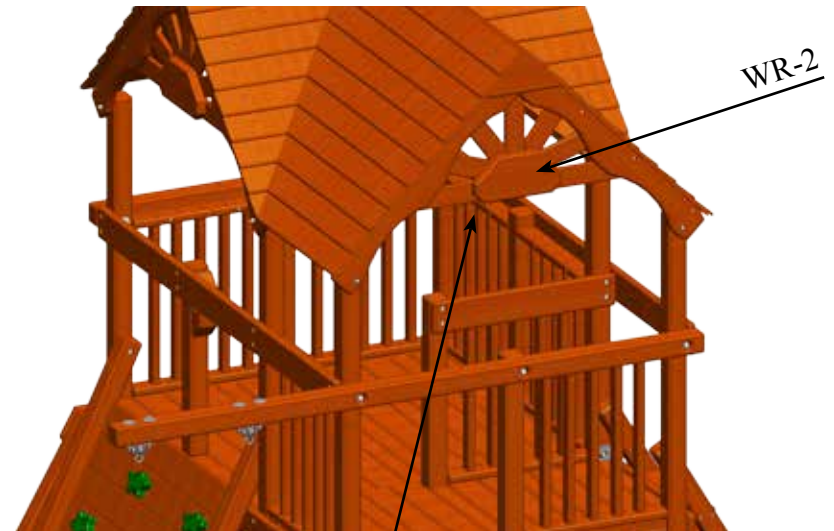
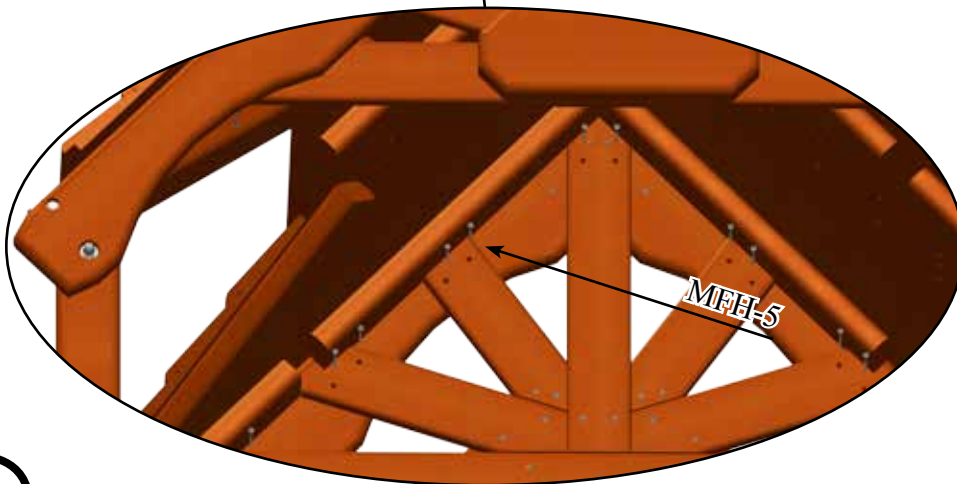
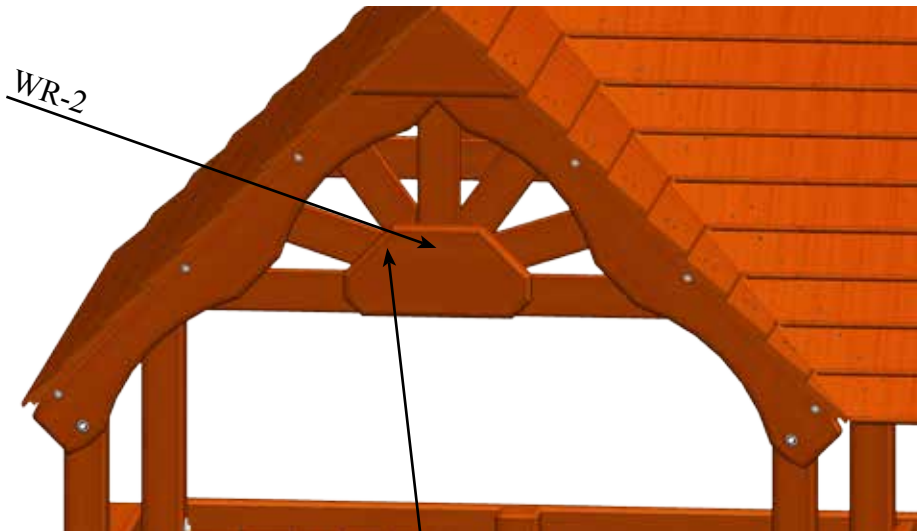

# MAIN ASSEMBLY

## PARTS NEEDED

WR-8- Megadeck (R) Bottom Dormer RW Panel- (1)

## HARDWARE NEEDED

MST-2- 1 1/4" Palygrip Safety Handle- (3)

MFH-11- 1/4" x 4 1/2" Hex Lag Screw- (2)

MFH-19- 1/4" USS Flatwasher- (2)

MFH-15- #14 x 2" Pan Phillips T/S (6)

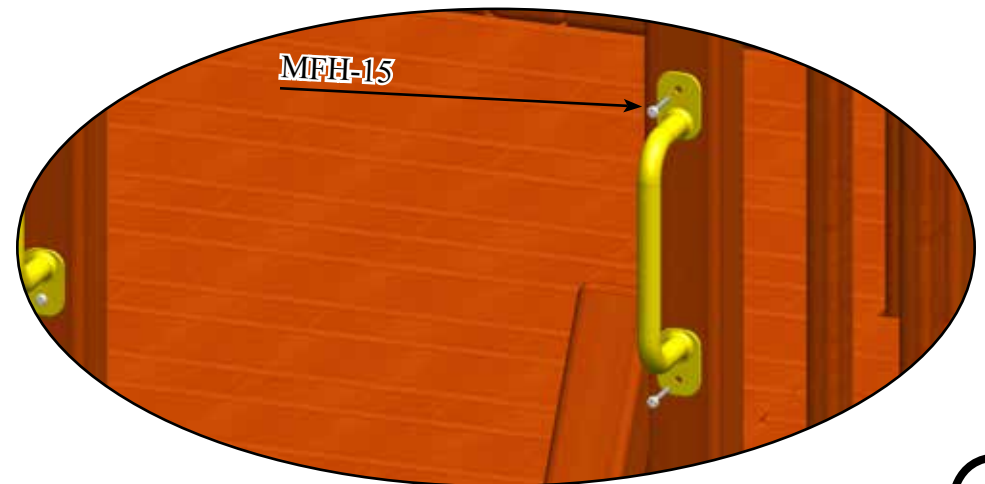
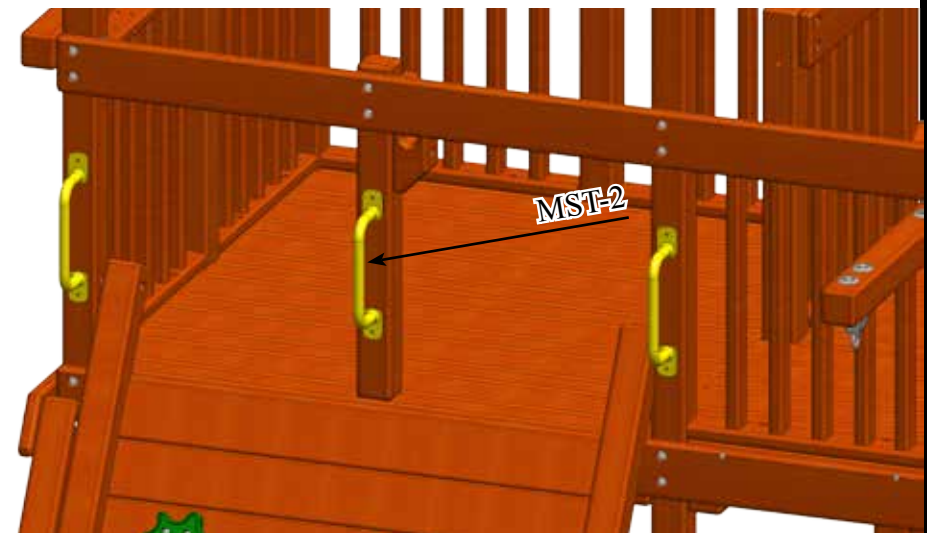

# MAIN ASSEMBLY

## PARTS NEEDED

## HARDWARE NEEDED

MST-2- 1 1/4" Playgrip Safety Handles- (2)  
MFH-15- #14 x 2" Pan Phillips T/S- (4)  
BXA-3- or BXB-3- Trapeze Bar W/ Rings- (1)

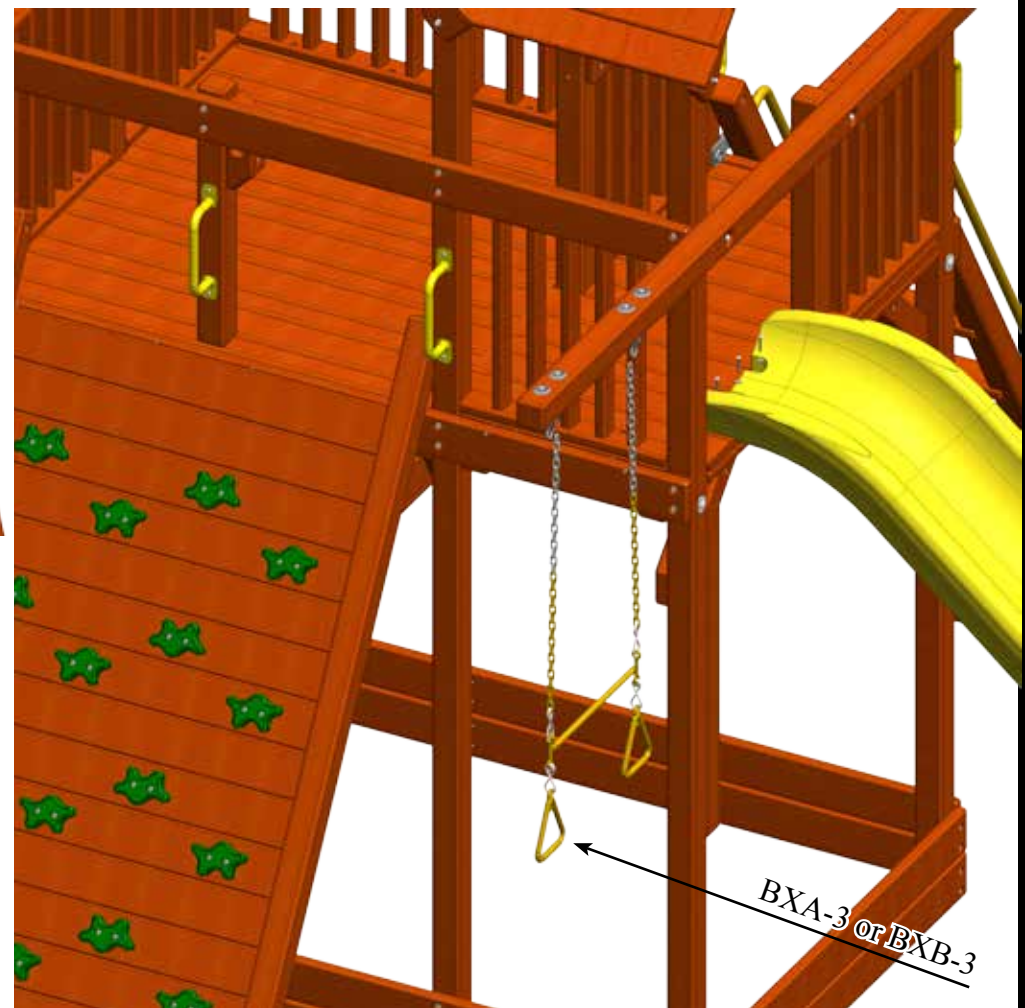
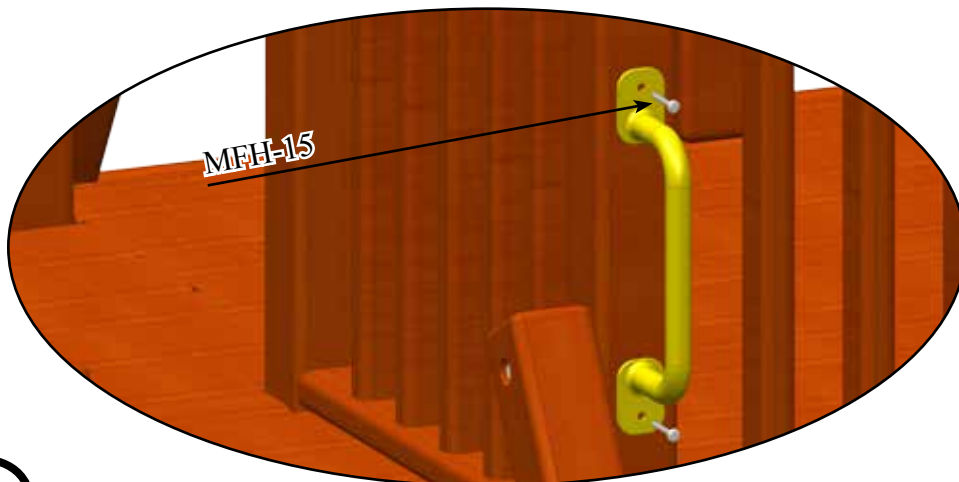



# MAIN ASSEMBLY

## PARTS NEEDED

## HARDWARE NEEDED

MST-3- 1 1/4" Playgrip Ladder Handles-	(2)
MFH-15- #14 x 2" Pan Phillips-	(7)
MFH-19- 1/4" USS Flatwasher-	(3)

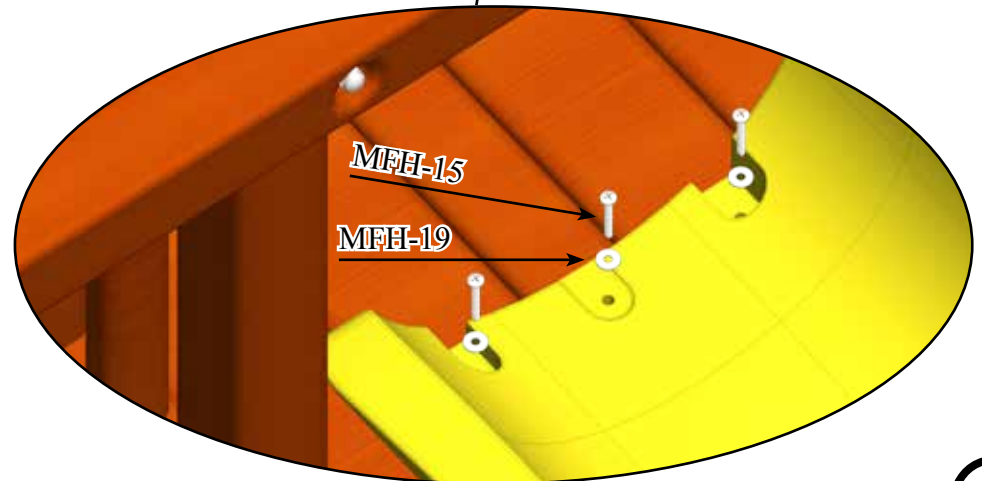
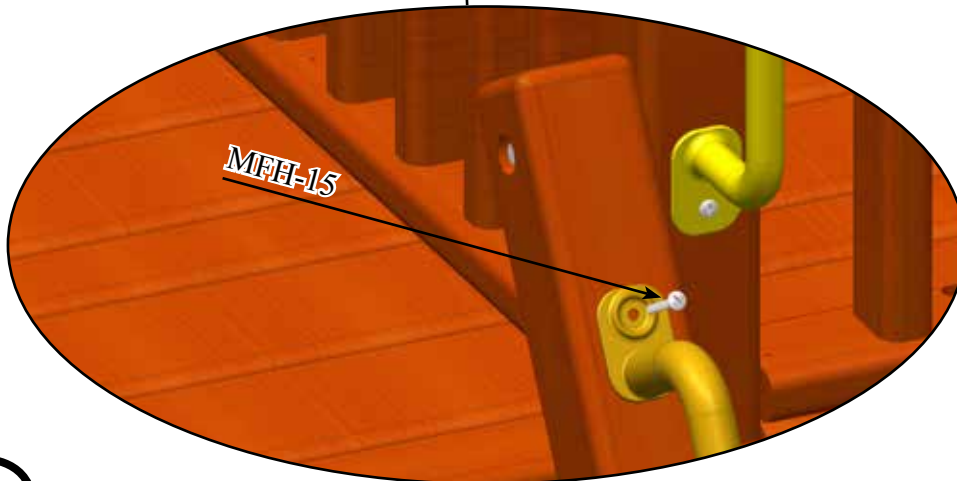
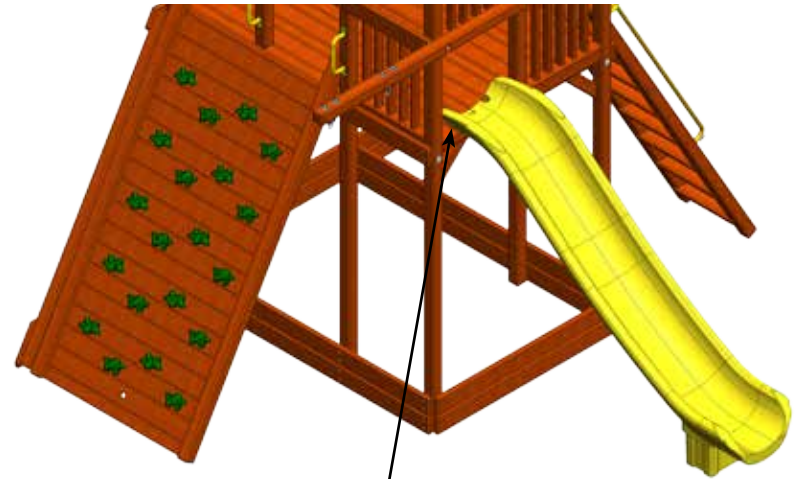

# MAIN ASSEMBLY

## PARTS NEEDED

(CTL+SHIFT+ Click to edit)



## HARDWARE NEEDED

(CTL+SHIFT+CLICK to edit)



String the rope through Universal Rope Block on the Fort tie a knot securing it in the rope block. Now tie a knot every 2 to 3 ft. until you can string through the RW Board w/ Rope Hole. Tie a knot securing it to the the board.



# 2013 TREE FROGS WARRANTY

Tree Frogs is proud to offer you our Limited 10 Year, 5 Year and 1 Year Warranty. (10/5/1)

Tree Frogs Warranties all Redwood and Cedar components against structural failure due to warping, wood rot, insect infestation (excluding Carpenter Bees) or decay for a period of 10 Years from the date of original purchase. A 10-Year limited Warranty also applies to all roto-molded slides, ductile iron swing hangers, all tire swivels, metal climbing rungs and swing beam brackets against failure due to rust or failure in defect in material. This warranty does not cover cracks, fissions, checks, fading, knots and weathering that are normal natural characteristics of wood, that do not affect the structural integrity of the product. Surface rust, fading, weathering, cracks/chips in coatings and corrosion that does not affect structural integrity is not covered by this warranty.

Furthermore, for a period of 5-Years, Tree Frogs limited warranties applies to all components & accessories (except ropes) that are not covered under the 10-Year Warranty to be free from defects in material and workmanship. This includes all blow molded slides. Surface rust, fading, weathering, cracks/chips in coatings and corrosion that does not affect structural integrity is not covered by this warranty.

And for a period of 1-Year Tree Frogs warranties all ropes to be free of defects in material and workmanship. This includes all structural foam molded slides. Fading is not considered a defect and may occur with seasonal and geographical conditions.

This warranty is limited to a repair or replacement of the defective part. Product covered under this warranty will be shipped at the customer's expense. Tree Frogs is not responsible for any expense associated with freight, or delivery and installation of the warranted part(s). Tree Frogs reserves the right to inspect all warranty claim parts for which a claim has been made.

This limited warranty applies only to the original retail purchaser and for residential use only. These warranties void when product is transferred or sold by original owner. A copy of the original invoice must be presented to initiate warranty claim. This limited warranty does not cover damage from abuse, acts of God, vandalism, negligence, alterations, normal wear & tear, use other than residential, unauthorized modification, damage due to moving of product or improper installation and or use. Any modification could damage the structural integrity of the play system and voids all warranties.

This warranty is exclusive and expressly in lieu of all other warranties, expressed or implied, including warranties of merchantability or fitness for use. Tree Frogs does not assume, or authorize any person to assume for us, any other liability in connection with the sale of our products.

This warranty gives you specific legal rights, and you also may have other rights that vary from state to state.

**\*\*WARRANTY EXCLUSIONS: Tower Kit (1 YR WARRANTY)**

**\*\*\*WARRANTY EXCLUSIONS: Toucan Fort, Toucan Playcenter (Limited 5Yr/5Yr/1Yr WARRANTY)**

Register your play system's warranty at [WWW.TREEFROGSSWINGSETS.COM](http://WWW.TREEFROGSSWINGSETS.COM).

Tree Frogs reserves the right at any time to change product specifications or substitute similar components.

See your owner's manual for the regular maintenance requirements & maintenance guidelines. Your child's play system & perimeter play zone should be inspected regularly for any wear & safety hazards.